



**US Army Corps  
of Engineers**  
Seattle District



WASHINGTON STATE  
DEPARTMENT OF  
E C O L O G Y

# Joint Public Notice

Application for a Department of the Army Permit and  
a Washington Department of Ecology Water Quality  
Certification and/or Coastal Zone Management  
Consistency Concurrence

**US Army Corps of Engineers**

Regulatory Branch  
Post Office Box 3755  
Seattle, WA 98124-3755  
Telephone: (206) 764-6904  
ATTN: Pamela Sanguinetti,  
Project Manager

**WA Department of Ecology**

SEA Program  
Post Office Box 47600  
Olympia, WA 98504-7600  
Telephone: (360) 407-6068  
ATTN: SEA Program,  
Federal Permit Coordinator

**Public Notice Date: March 2, 2015**

Expiration Date: April 1, 2015  
  
Reference No.: NWS-2014-283  
Name: Astronics Advanced Electronic  
Systems

Interested parties are hereby notified that the U.S. Army Corps of Engineers (Corps) and the Washington Department of Ecology (Ecology) have received an application to perform work in waters of the U.S. as described below and shown on the enclosed drawings dated January 29, 2015.

The Corps will review the work in accordance with Section 404 of the Clean Water Act (CWA). Ecology will review the work pursuant to Section 401 of the CWA, with applicable provisions of State water pollution control laws and the Coastal Zone Management Act.

APPLICANT: Mr. Tim Borland  
Astronics Advanced Electronic Systems  
12950 Willows Road Northeast  
Kirkland, Washington 98034  
Telephone: (425) 881-1700

AGENT: William E. Shiels  
Talasaea Consultants, Incorporated  
15020 Bear Creek Road Northeast  
Woodinville, Washington 98077  
Telephone: (425) 861-7550

LOCATION: In wetlands adjacent to the Sammamish River at 12950 Willows Road Northeast, Kirkland, Washington 98034.

WORK: Fill 0.70 of an acre of wetlands to construct a three-story 130,000-square-foot building and parking and associated infrastructure. Parking would be a combination of surface and five-level structured.

PURPOSE: To provide commercial space to accommodate current and anticipated production and staffing levels.

MITIGATION: Impacts to wetlands are proposed to be mitigated by purchasing credits from the King County Mitigation Reserves In-Lieu Fee Program. The project site is located within the Sammamish River Service Area

and the credits purchased will fund mitigation within the service area. Additional mitigation is proposed to restore 2280 square feet of riparian buffer to an unnamed stream on the property. No impacts to the stream are proposed.

ENDANGERED SPECIES: The Endangered Species Act (ESA) requires federal agencies to consult with the National Marine Fisheries Service (NMFS) and/or U.S. Fish and Wildlife Service pursuant to Section 7 of the ESA on all actions that may affect a species listed (or proposed for listing) under the ESA as threatened or endangered or any designated critical habitat. After receipt of comments from this public notice, the U.S. Army Corps of Engineers will evaluate the potential impacts to proposed and/or listed species and their designated critical habitat.

ESSENTIAL FISH HABITAT: The Magnuson-Stevens Fishery Conservation and Management Act, as amended by the Sustainable Fisheries Act of 1996, requires all Federal agencies to consult with the NMFS on all actions, or proposed actions, permitted, funded, or undertaken by the agency, that may adversely affect Essential Fish Habitat (EFH). The Corps has determined that the proposed action will not adversely affect designated EFH for federally managed fisheries in Washington waters. No further EFH consultation is necessary.

CULTURAL RESOURCES: The Corps has reviewed the latest published version of the National Register of Historic Places, Washington Information System for Architectural and Archaeological Records Data and other sources of information. A historic properties investigation was prepared for this project by Tetra Tech. No historic properties were located as a result of this investigation. The Corps invites responses to this public notice from Native American Tribes or tribal governments; Federal, State, and local agencies; historical and archeological societies; and other parties likely to have knowledge of or concerns regarding historic properties and sites of religious and cultural significance at or near the project area. After receipt of comments from this public notice, the Corps will evaluate potential impacts and consult with the State Historic Preservation Officer and Native American Tribes in accordance with Section 106 of the National Historic Preservation Act, as appropriate.

PUBLIC HEARING: Any person may request, in writing, within the comment period specified in this notice, that a public hearing be held to consider this application. Requests for public hearings shall state, with particularity, the reasons for holding a public hearing.

EVALUATION – CORPS: The decision whether to issue a permit will be based on an evaluation of the probable impacts, including cumulative impacts, of the proposed activity on the public interest. That decision will reflect the national concern for both protection and utilization of important resources. The benefits, which reasonably may be expected to accrue from the proposal, must be balanced against its reasonably foreseeable detriments. All factors which may be relevant to the proposal will be considered, including the cumulative effects thereof; among those are conservation, economics, aesthetics, general environmental concerns, wetlands, historic properties, fish and wildlife values, flood hazards, floodplain values, land use, navigation, shoreline erosion and accretion, recreation, water supply and conservation, water quality, energy needs, safety, food and fiber production, mineral needs, considerations of property ownership, and, in general, the needs and welfare of the people.

The Corps is soliciting comments from the public; Native American Nations or tribal governments; Federal, State, and local agencies and officials; and other interested parties in order to consider and evaluate the impacts of this activity. Any comments received will be considered by the Corps to determine whether to issue, modify, condition or deny a permit for the work. To make this decision, comments are used to assess impacts on endangered species, historic properties, water quality, general environmental effects, and the other public interest factors listed above. Comments are used in the preparation of an Environmental Assessment and/or an Environmental Impact Statement pursuant to the National Environmental Policy Act. Comments are also used to determine the need for a public hearing and to determine the overall public interest of the activity.

The described discharge will be evaluated for compliance with guidelines promulgated by the Environmental Protection Agency under authority of Section 404(b)(1) of the CWA. These guidelines require an analysis of alternatives for any proposed discharge of dredged or fill material into waters of the United States.

SOURCE OF FILL MATERIAL: The source of the fill material will be subsoil material sources from on-site, cut-and-fill excavation and grading work and, if needed. Imported fill material selected from a source approved by the City of Kirkland. Should a permit be issued, the Corps will evaluate any imported fill material source prior to the start of construction.

EVALUATION – ECOLOGY: Ecology is soliciting comments from the public; Federal, Native American Nations or tribal governments, State, and local agencies and officials; and other interested parties in order to consider and evaluate the impacts of this activity. Ecology will be considering all comments to determine whether to certify or deny certification for the proposed project.

COMMENT AND REVIEW PERIOD: Conventional mail or e-mail comments on this public notice will be accepted and made part of the record and will be considered in determining whether authorizing the work would not be contrary to the public interest. In order to be accepted, e-mail comments must originate from the author's e-mail account and must include on the subject line of the e-mail message the permit applicant's name and reference number as shown below. Either conventional mail or e-mail comments must include the permit applicant's name and reference number, as shown below, and the commenter's name, address, and phone number. All comments whether conventional mail or e-mail must reach this office, no later than the expiration date of this public notice to ensure consideration.

Copies of this public notice which have been mailed or otherwise physically distributed feature project drawings in black and white. The electronic version features those drawings in color, which we think more accurately communicates the scope of project impacts. To access the electronic version of this public notice, go to the Seattle District's web page at <http://www.nws.usace.army.mil/> and under the heading Open Public Comment Periods select Regulatory Public Notices. Recently-issued public notices are listed in chronological order of the date of issuance. Select and view the listing for this project.

CORPS COMMENTS: All e-mail comments should be sent to [pamela.sanguinetti@usace.army.mil](mailto:pamela.sanguinetti@usace.army.mil). Conventional mail comments should be sent to: U.S. Army Corps of Engineers, Regulatory Branch, Attention: Pamela Sanguinetti, Project Manager, P.O. Box 3755, Seattle, Washington 98124-3755. All comments received will become part of the administrative record and are subject to public release under the Freedom of Information Act including any personally identifiable information such as names, phone numbers, and addresses.

ECOLOGY COMMENTS: Any person desiring to present views on the project pertaining to a request for water quality certification under Section 401 of the CWA and/or Coastal Zone Management consistency concurrence, may do so by submitting written comments to the following address: Washington State Department of Ecology, Attention: Federal Permit Coordinator, P.O. Box 47600, Olympia, Washington 98504-7600, or e-mail to [ecyrefedpermits@ecy.wa.gov](mailto:ecyrefedpermits@ecy.wa.gov).

To ensure proper consideration of all comments, responders must include the following name and reference number in the text of their comments: Astronics Advanced Electronic Systems; NWS-2014-283

Encl: Figures (11)

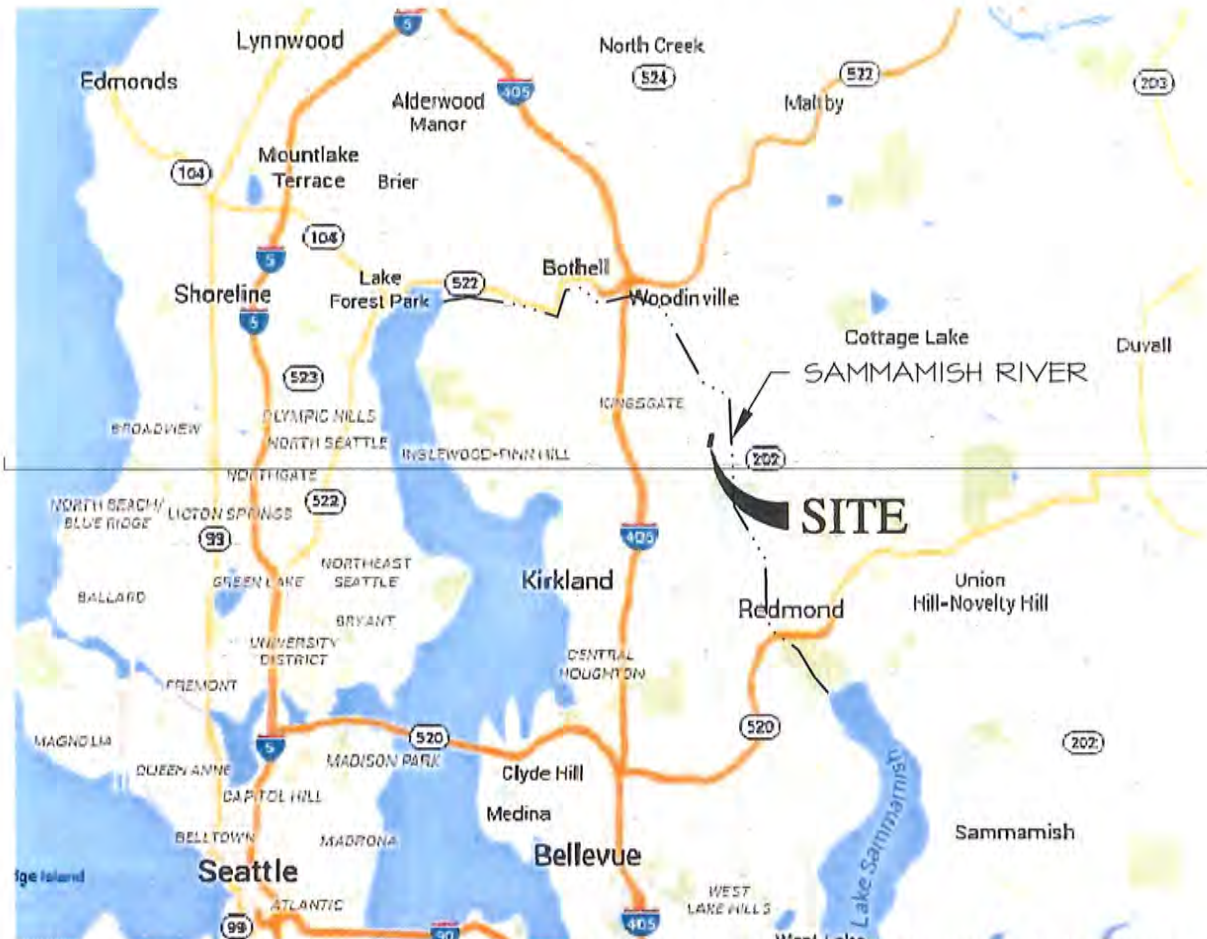

IMAGE SOURCE: PROVIDED BY BARGHAUSEN CONSULTING ENGINEERS

**DRIVING DIRECTIONS:**

1. FROM SEATTLE TAKE HWY 520 EAST TO REDMOND
2. FROM HWY 520E, TAKE EXIT 168B TO MERGE ONTO I-405 NORTH TOWARD EVERETT
3. TAKE EXIT 20B FOR NE 124TH STREET
4. CONTINUE ON 124TH STREET, TURN LEFT ONTO WILLOWS RD NE
5. TAKE FIRST RIGHT ONTO 141ST AVE NE

ARRIVE AT DESTINATION  
 ASTRONICS AES  
 12950 WILLOWS RD NE  
 KIRKLAND, WASHINGTON 98034

EXPANSION PROJECT LOCATED NORTH OF EXISTING OFFICE BUILDINGS

<b>PROJECT SITE PARCELS</b>	
1.	222605-9042 - ASTRONICS ADVANCED ELECTRONICS
2.	222605-9053 - ASTRONICS ADVANCED ELECTRONICS
3.	222605-9080 - ASTRONICS ADVANCED ELECTRONICS
<b>ADJACENT PROPERTY OWNERS</b>	
1.	222605-9021 - ASTRONICS ADVANCED ELECTRONICS
2.	222605-9030 - KING COUNTY PARKS 4602II
3.	222605-9108 - WASHINGTON TRUST BANK
4.	222605-9121 - KING COUNTY PARKS



<p><b>TALASAEA</b>                  CONSULTANTS, INC.                  Resource &amp; Environmental Planning                  15020 Bear Creek Road Northeast                  Woodinville, Washington 98077                  Bus (425)861-7550 - Fax (425)861-7549</p>	<b>FIGURE TITLE</b> VICINITY MAP & DIRECTIONS		<b>DRAWN</b> ABS	<b>TAL#</b> 1467
	<b>REFERENCE</b> NWS-2014-0283	<b>APPLICANT</b> ASTRONICS AES CORPORATION		<b>LAT. &amp; LONG.</b> 47.7203, -122.1515
	<b>PROPOSED PROJECT:</b> ASTRONICS EXPANSION			
	<b>PURPOSE:</b> OFFICE & MFG. FACILITY EXPANSION			
	<b>ADDRESS:</b> 12950 WILLOWS RD NE			
<b>CITY</b> KIRKLAND	<b>COUNTY</b> KING	<b>STATE</b> WA	<b>IN</b> UNNAMED WETLANDS	
			<b>DATE</b> 9-9-2014	<b>REVISED</b> 1-29-2015
			<b>FIGURE #</b>	<b>OF</b>



SE ¼, SEC. 22, TWP. 26N, RGE. 5E, W.M.

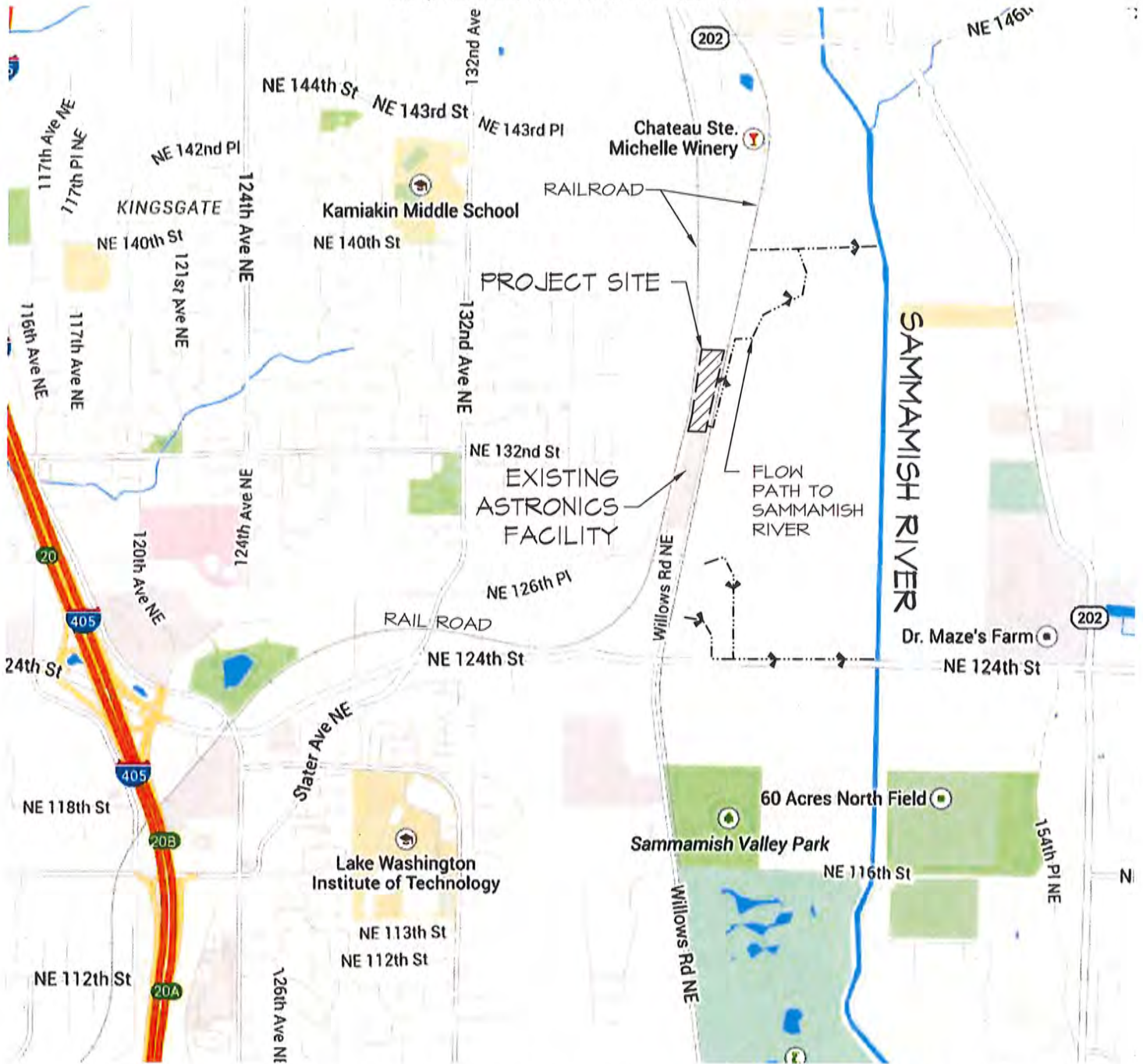



IMAGE SOURCE: GOOGLE MAPS, WWW.MAPS.GOOGLE.COM (ACCESSED 27 JANUARY 2015)



 <p><b>TALASAEA</b> CONSULTANTS, INC. Resource &amp; Environmental Planning 15020 Bear Creek Road Northeast Woodinville, Washington 98077 Bus (425)861-7550 - Fax (425)861-7549</p>	FIGURE TITLE ENLARGED VICINITY MAP		DRAWN ABS	TAL# 1467
	REFERENCE NWS-2014-0283	APPLICANT ASTRONICS AES CORPORATION		LAT. & LONG. 47.7203, -122.1515
	PROPOSED PROJECT: ASTRONICS EXPANSION			
	PURPOSE: OFFICE & MFG. FACILITY EXPANSION			
	ADDRESS: 12950 WILLOWS RD NE			
CITY KIRKLAND	COUNTY KING	STATE WA	IN UNNAMED WETLANDS	
			FIGURE #	<b>2</b> OF <b>11</b>

SE 1/4, SEC. 22, TWP. 26N, RGE. 5E, W.M.

222605-9108

WASHINGTON TRUST BANK

MATCHLINE TO LEFT

WETLAND D  
CAT. III (DOE)  
TYPE 3 (CITY)  
4,783 SF

WETLAND C  
CAT. III (DOE)  
TYPE 3 (CITY)  
20,090 SF

222605-9027  
ASTRONICS  
ADVANCED  
ELECTRONICS

RAIL ROAD

PARCEL C

PROJECT SITE  
BOUNDARY

STORMWATER  
POND

EXISTING  
ASTRONICS  
BUILDING

RAIL ROAD

EXISTING  
ASTRONICS  
BUILDING

WETLAND E  
CAT. III (DOE)  
TYPE 3 (CITY)  
5,731 SF

PARCEL B

25' EXISTING  
SANITARY SEWER  
EASEMENT

RAIL ROAD

RAIL ROAD

222605-9121 KING COUNTY PARKS

STREAM I  
TYPE NP

PARCEL A

WETLAND B  
CAT. III (DOE)  
TYPE 2 (CITY)  
835 SF

WETLAND A  
CAT. III (DOE)  
TYPE 3 (CITY)  
632 SF (ON-SITE)

GRAPHIC SCALE  
( IN FEET )

NORTH



SCALE: 1" = 150'

MATCHLINE TO RIGHT

**TALASAEA**  
CONSULTANTS, INC.  
Resource & Environmental Planning  
15020 Bear Creek Road Northeast  
Woodinville, Washington 98077  
Bus (425)861-7550 - Fax (425)861-7549

FIGURE TITLE EXISTING CONDITIONS OVERVIEW		DRAWN ABS	TAL# 1467
REFERENCE NWS-2014-0283	APPLICANT ASTRONICS AES CORPORATION		LAT. & LONG. 47.7203, -122.1515
PROPOSED PROJECT: ASTRONICS EXPANSION			DATE 9-9-2014
PURPOSE: OFFICE & MFG. FACILITY EXPANSION			REVISED 1-29-2015
ADDRESS: 12450 WILLOWS RD NE			
CITY KIRKLAND	COUNTY KING	STATE WA	IN UNNAMED WETLANDS

FIGURE # **3** OF **11**

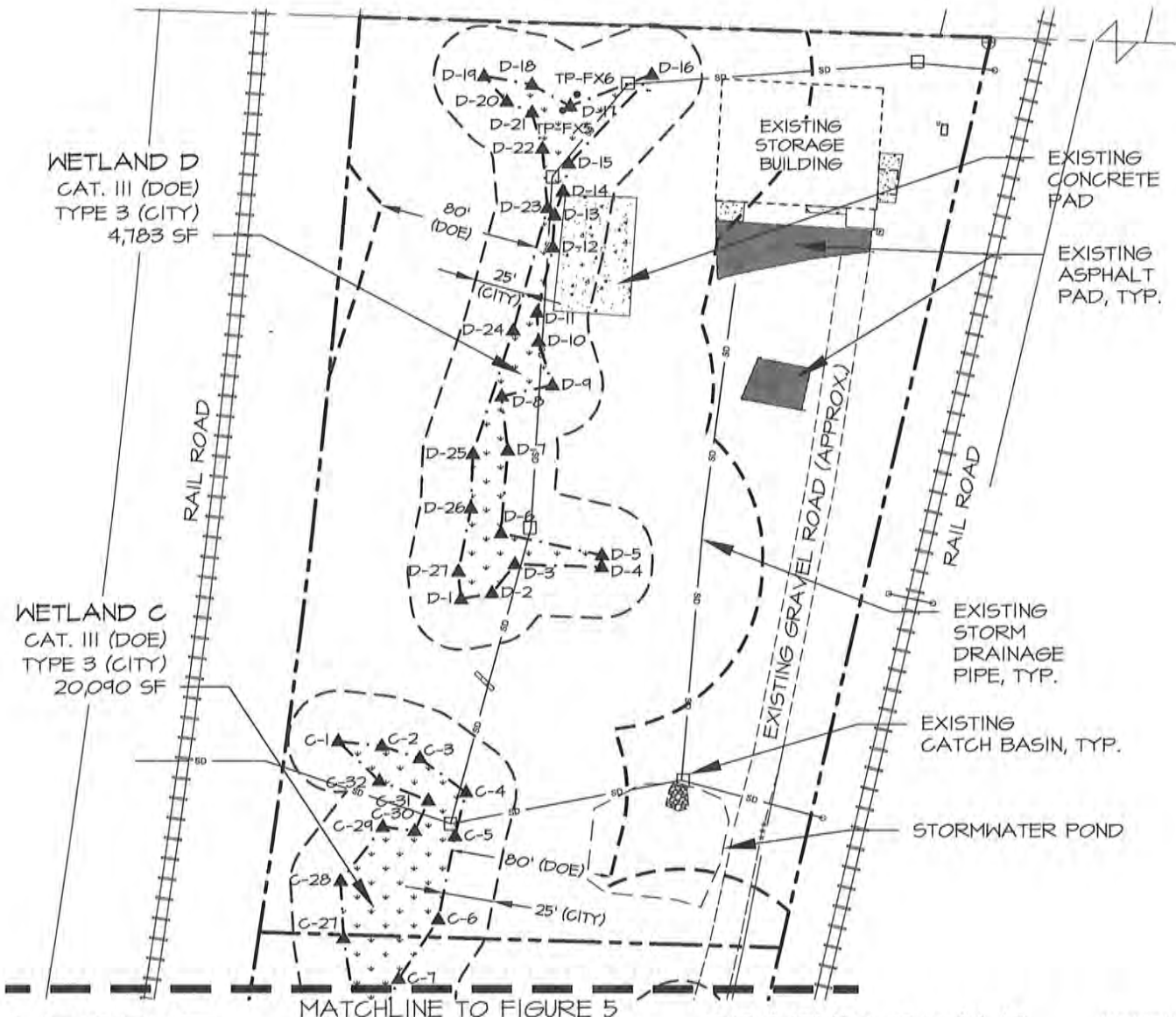

### LEGEND

- PROJECT SITE BOUNDARY
- EXISTING WETLAND
- WETLAND BUFFER PER CORPS/DOE GUIDANCE
- WETLAND BUFFER PER CITY OF KIRKLAND
- STREAM BUFFER
- WETLAND FLAG
- TESTPIT

### GRAPHIC SCALE (IN FEET)

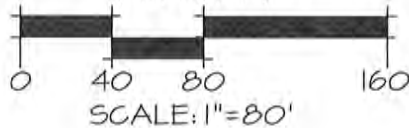

<p><b>TALASAEA</b> CONSULTANTS, INC. Resource &amp; Environmental Planning 15020 Bear Creek Road Northeast Woodinville, Washington 98077 Bus (425)861-7550 - Fax (425)861-7549</p>	<b>FIGURE TITLE</b> EXISTING CONDITIONS - NORTH		<b>DRAWN</b> ABS	<b>TAL#</b> 1467
	<b>REFERENCE</b> NWS-2014-0283	<b>APPLICANT</b> ASTRONICS AES CORPORATION		<b>LAT. &amp; LONG.</b> 47.1203, -122.1515
	<b>PROPOSED PROJECT:</b> ASTRONICS EXPANSION			
	<b>PURPOSE:</b> OFFICE & MFG. FACILITY EXPANSION			
	<b>ADDRESS:</b> 12950 WILLOWS RD NE			
<b>CITY</b> KIRKLAND	<b>COUNTY</b> KING	<b>STATE</b> WA	<b>IN</b> UNNAMED WETLANDS	
			<b>DATE</b> 9-9-2014	<b>REVISED</b> 1-29-2015
<b>FIGURE #</b> 4 OF 11				



MATCHLINE TO FIGURE 4

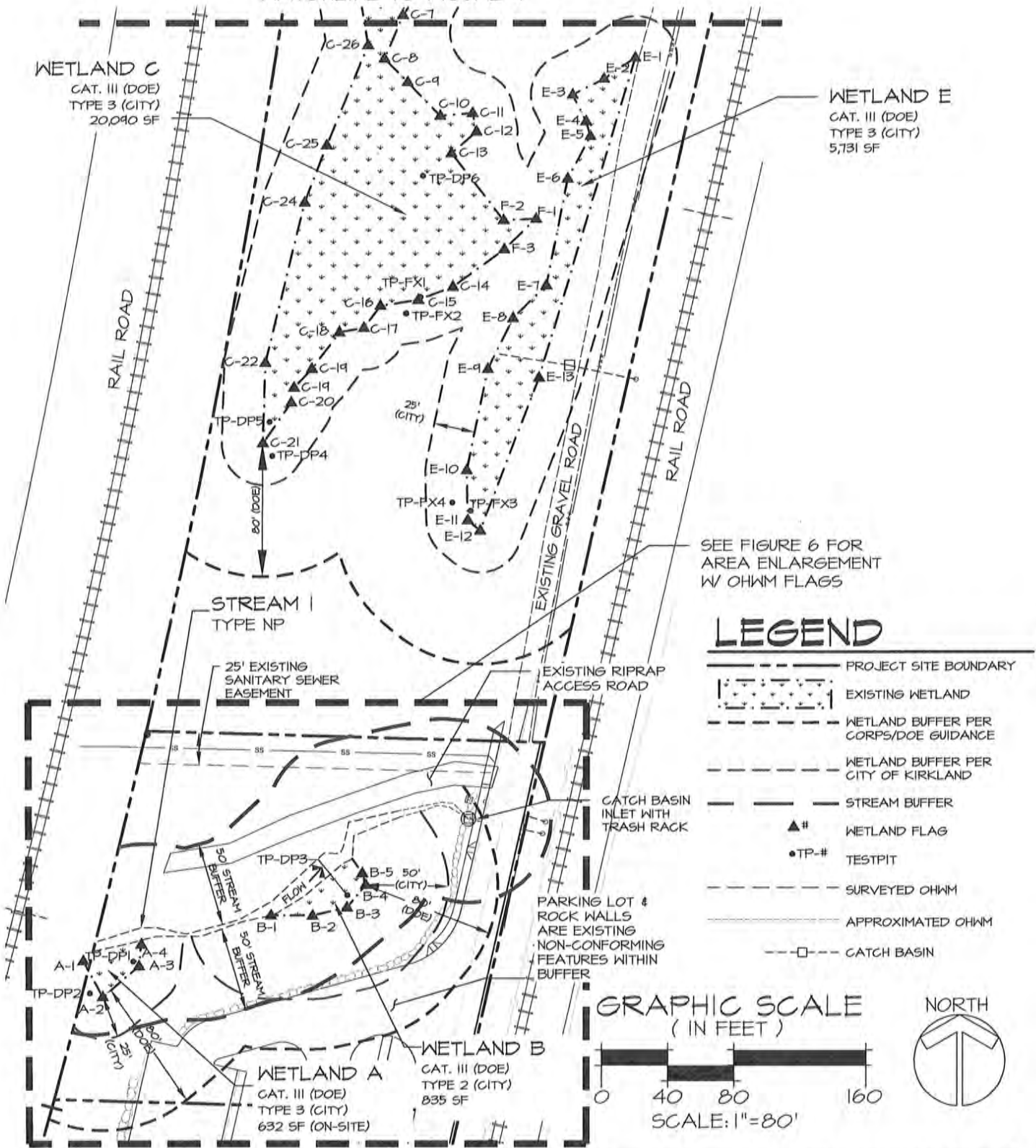

**TALASAEA CONSULTANTS, INC.**  
Resource & Environmental Planning  
15020 Bear Creek Road Northeast  
Woodinville, Washington 98077  
Bus (425)861-7550 - Fax (425)861-7549

<b>FIGURE TITLE</b> EXISTING CONDITIONS - SOUTH		<b>DRAWN</b> ABS	<b>TAL#</b> 1467
<b>REFERENCE</b> NWS-2014-0283	<b>APPLICANT</b> ASTRONICS AES CORPORATION	<b>LAT. &amp; LONG.</b> 47.7203, -122.1515	
<b>PROPOSED PROJECT:</b> ASTRONICS EXPANSION			
<b>PURPOSE:</b> OFFICE & MFG. FACILITY EXPANSION			
<b>ADDRESS:</b> 12450 WILLOWS RD NE			
<b>CITY</b> KIRKLAND	<b>COUNTY</b> KING	<b>STATE</b> WA	<b>IN</b> UNNAMED WETLANDS

**DATE**  
9-9-2014

**REVISED**  
1-29-2015

**FIGURE #** 5 OF 11



SE 1/4, SEC. 22, TWP. 26N, RGE. 5E, W.M.

APPROXIMATE  
OHWM  
(NOT SURVEYED)

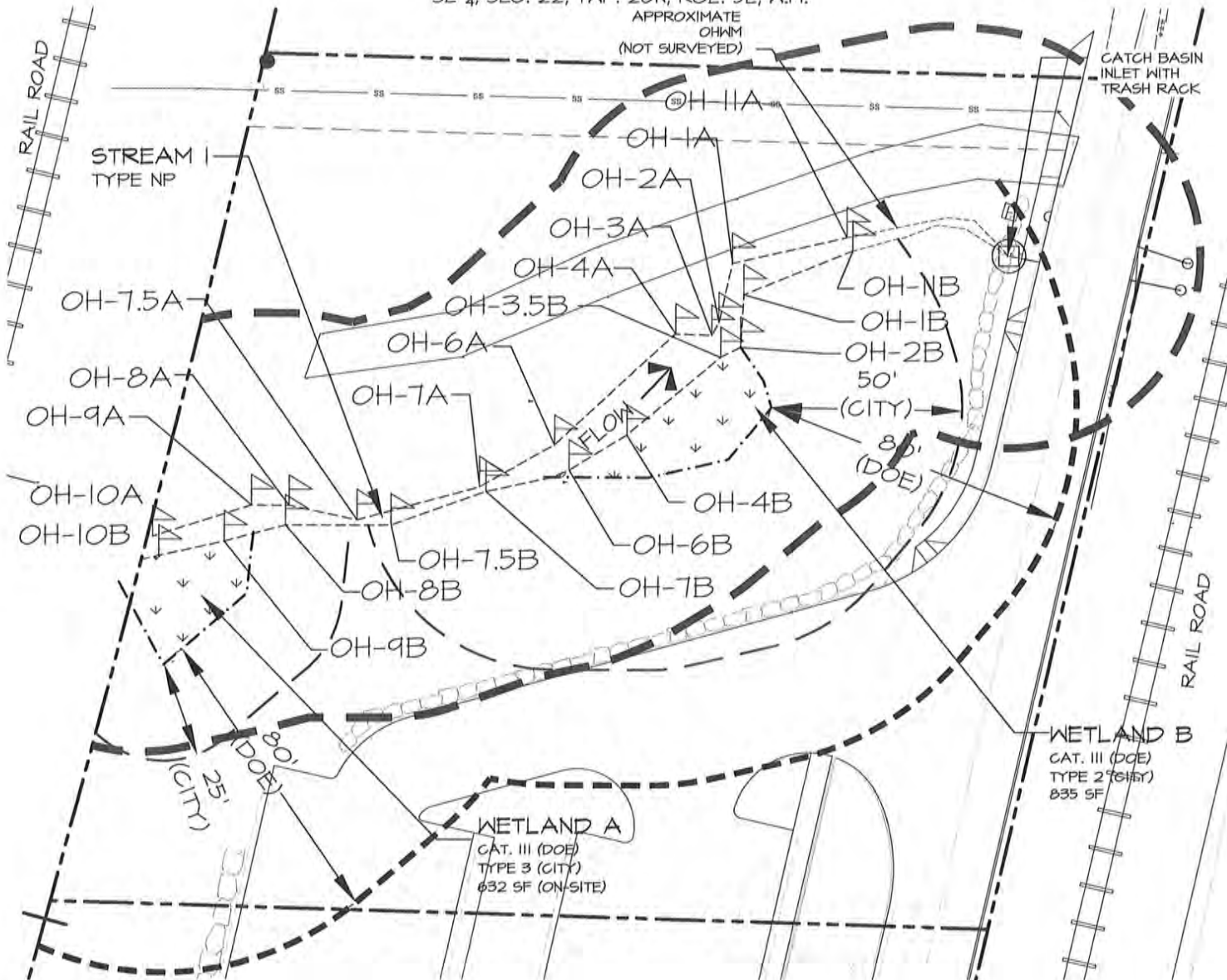

## LEGEND

- PROJECT SITE BOUNDARY
- EXISTING WETLAND
- WETLAND BUFFER PER CORPUS/DOE GUIDANCE
- WETLAND BUFFER PER CITY OF KIRKLAND
- STREAM BUFFER
- SURVEYED OHWM
- APPROXIMATED OHWM
- FOH-# OHWM FLAG

GRAPHIC SCALE  
( IN FEET )

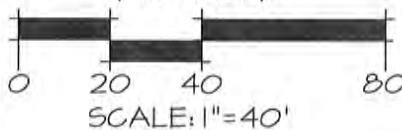

NORTH



**TALASAEA**  
CONSULTANTS, INC.

Resource & Environmental Planning

15020 Bear Creek Road Northeast  
Woodinville, Washington 98077  
Bus (425)861-7550 - Fax (425)861-7549

FIGURE TITLE  
EXISTING CONDITIONS - STREAM ENLARGEMENT

REFERENCE APPLICANT  
NW5-2014-0283 ASTRONICS AES CORPORATION

PROPOSED PROJECT: ASTRONICS EXPANSION  
PURPOSE: OFFICE & MFG. FACILITY EXPANSION

ADDRESS: 12950 WILLOWS RD NE

CITY COUNTY STATE IN  
KIRKLAND KING WA UNNAMED WETLANDS

DRAWN TAL#  
ABS 1467

LAT. & LONG.  
47.7203, -122.1515

DATE REVISED  
9-9-2014 1-29-2015

FIGURE # **6** OF **11**

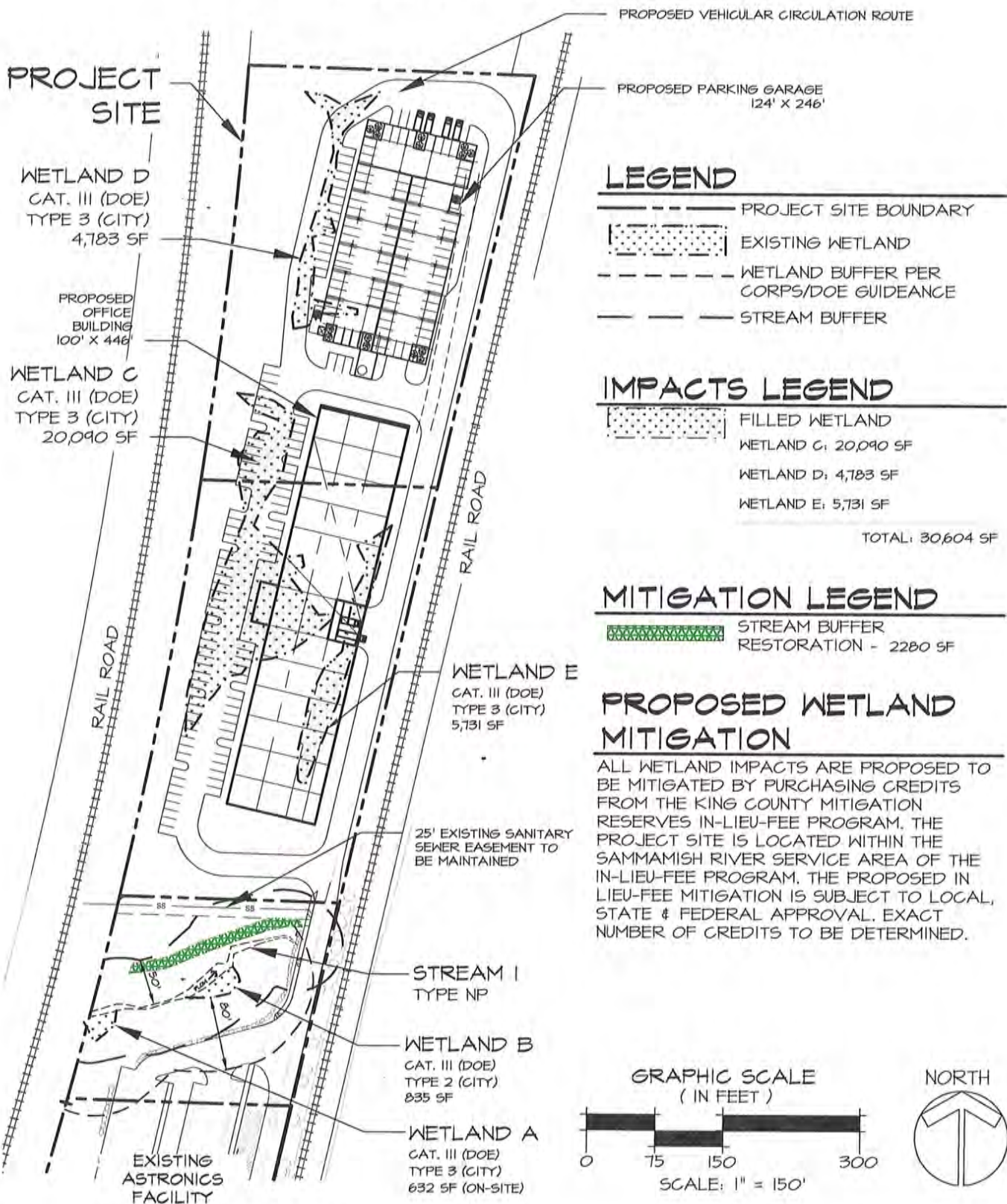

**TALASAEA CONSULTANTS, INC.**  
Resource & Environmental Planning  
15020 Bear Creek Road Northeast  
Woodinville, Washington 98077  
Bus (425)861-7550 - Fax (425)861-7549

<b>FIGURE TITLE</b> PROPOSED SITE PLAN, IMPACTS AND MITIGATION		<b>DRAWN</b> ABS	<b>TAL#</b> 1467
<b>REFERENCE</b> NWS-2014-0283	<b>APPLICANT</b> ASTRONICS AES CORPORATION		<b>LAT. &amp; LONG.</b> 47.7203, -122.1515
<b>PROPOSED PROJECT:</b> ASTRONICS EXPANSION		<b>DATE</b> 9-9-2014	<b>REVISED</b> 1-29-2015
<b>PURPOSE:</b> OFFICE & MFG. FACILITY EXPANSION		<b>FIGURE #</b> 7 <b>OF</b> 11	
<b>ADDRESS:</b> 12950 WILLOWS RD NE			
<b>CITY</b> KIRKLAND	<b>COUNTY</b> KING	<b>STATE</b> WA	<b>IN</b> UNNAMED WETLANDS



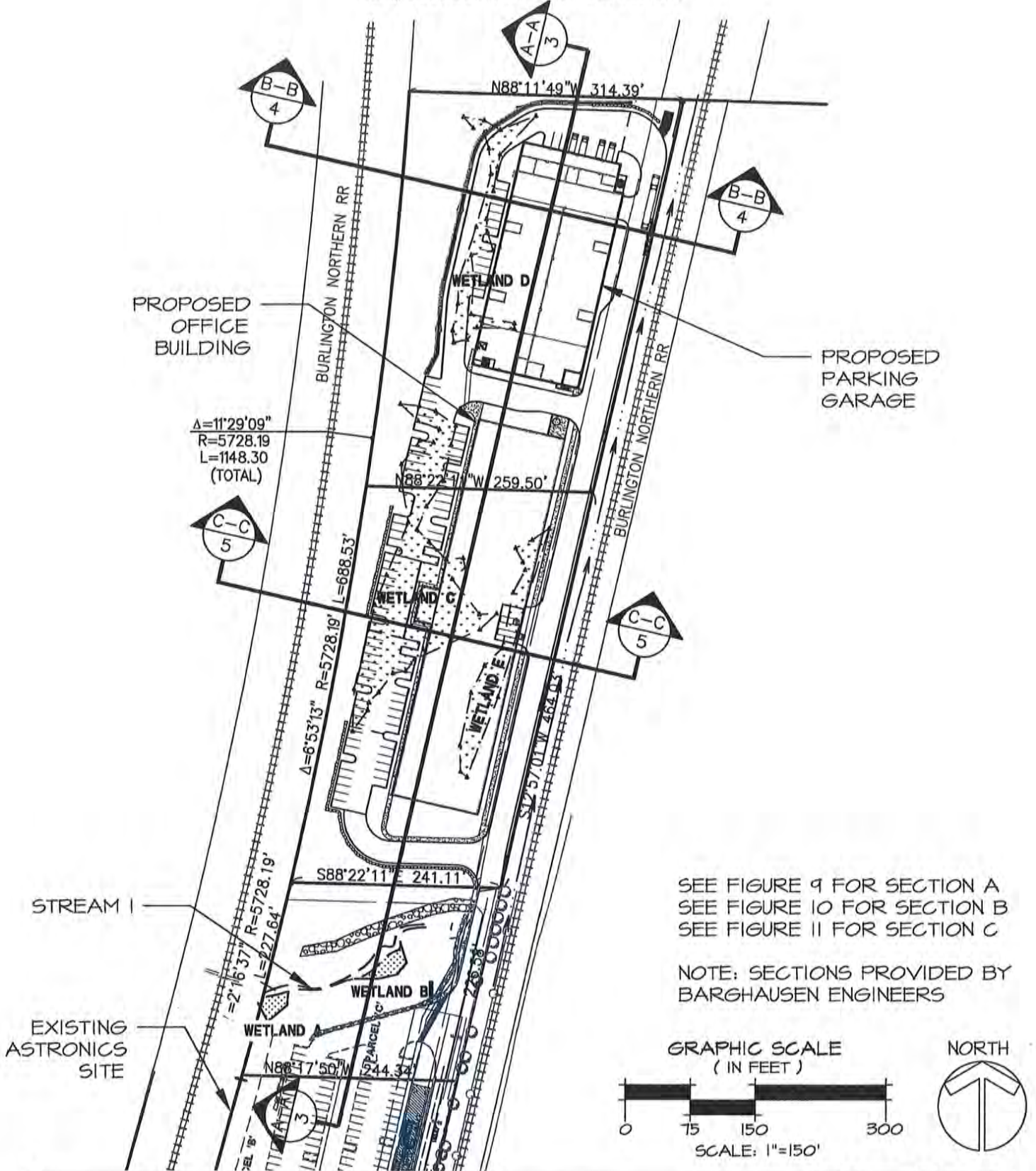

SEE FIGURE 9 FOR SECTION A  
 SEE FIGURE 10 FOR SECTION B  
 SEE FIGURE 11 FOR SECTION C

NOTE: SECTIONS PROVIDED BY BARGHAUSEN ENGINEERS

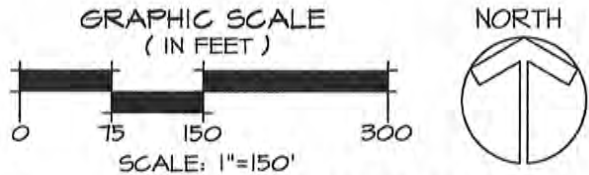

<p><b>TALASAEA CONSULTANTS, INC.</b>                  Resource &amp; Environmental Planning                  15020 Bear Creek Road Northeast                  Woodinville, Washington 98077                  Bus (425)861-7550 - Fax (425)861-7549</p>	<b>FIGURE TITLE</b> SECTION OVERVIEW		DRAWN ABS	TAL# 1467
	<b>REFERENCE</b> NWS-2014-0283	<b>APPLICANT</b> ASTRONICS AES CORPORATION		LAT. & LONG. 47.7203, -122.1515
	<b>PROPOSED PROJECT:</b> ASTRONICS EXPANSION			
	<b>PURPOSE:</b> OFFICE & MFG. FACILITY EXPANSION			
	<b>ADDRESS:</b> 12950 WILLOWS RD NE			
CITY KIRKLAND	COUNTY KING	STATE WA	IN UNNAMED WETLANDS	
			DATE 9-9-2014	REVISED 1-29-2015
FIGURE # <b>8</b> OF <b>11</b>				

SE 1/4, SEC 22, TWP. 26N, RGE. 5E, W.M.

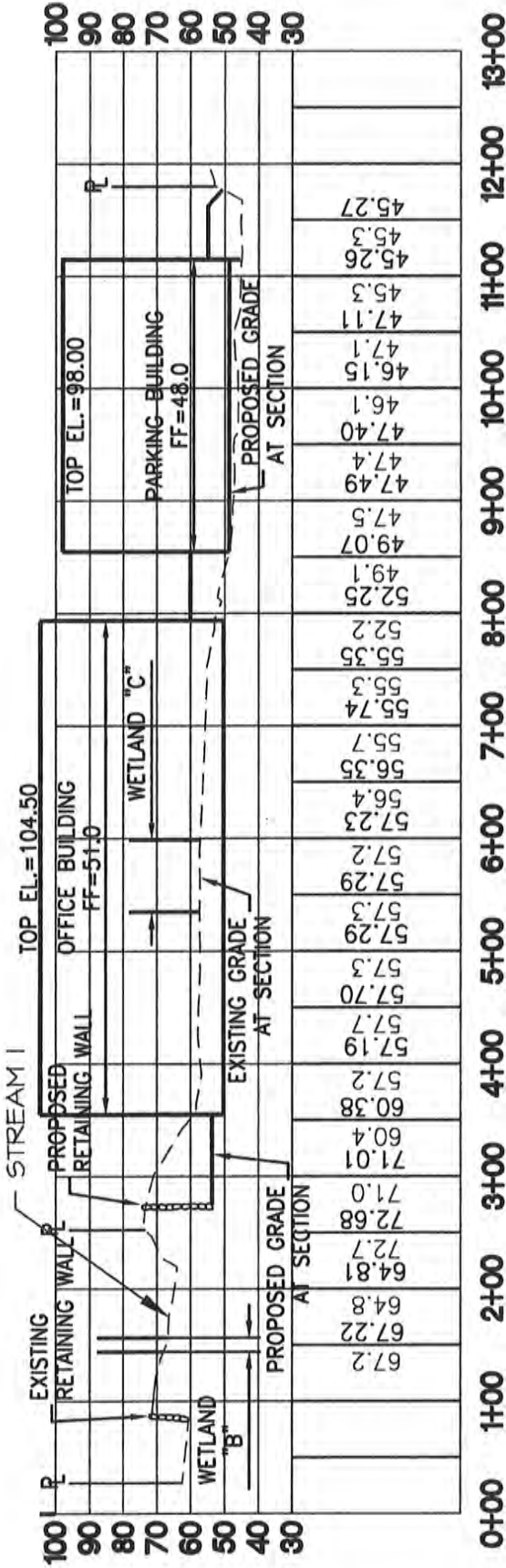

**A-A**  
**3**  
**SITE SECTION**  
SCALE: H: 1"=150' V: 1"=50'

NOTE: SECTIONS PROVIDED BY BARGHAUSEN ENGINEERS

<p><b>TALASAEA CONSULTANTS, INC.</b> Resource &amp; Environmental Planning 15020 Bear Creek Road Northeast Woodinville, Washington 98077 Bus (425)861-7550 - Fax (425)861-7549</p>		<p>FIGURE TITLE SECTION A</p>	<p>DRAWN ABS</p>	<p>TAL # 1467</p>
<p>REFERENCE NW6-2014-0283</p>	<p>APPLICANT ASTRONICS AES CORPORATION</p>	<p>LAT. &amp; LONG. 47.1203, -122.1515</p>	<p>DATE 9-9-2014</p>	<p>REVISED 1-24-2015</p>
<p>PURPOSE: OFFICE &amp; MFG. FACILITY EXPANSION</p>	<p>ADDRESS: 12450 WILLOWS RD NE</p>	<p>CITY KIRKLAND</p>	<p>COUNTY KING</p>	<p>STATE WA</p>
<p>CITY KIRKLAND</p>	<p>COUNTY KING</p>	<p>STATE WA</p>	<p>UNNAMED WETLANDS</p>	<p>FIGURE # 9 OF 11</p>



SE 1/4, SEC 22, TWP. 26N, RGE. 5E, WM.

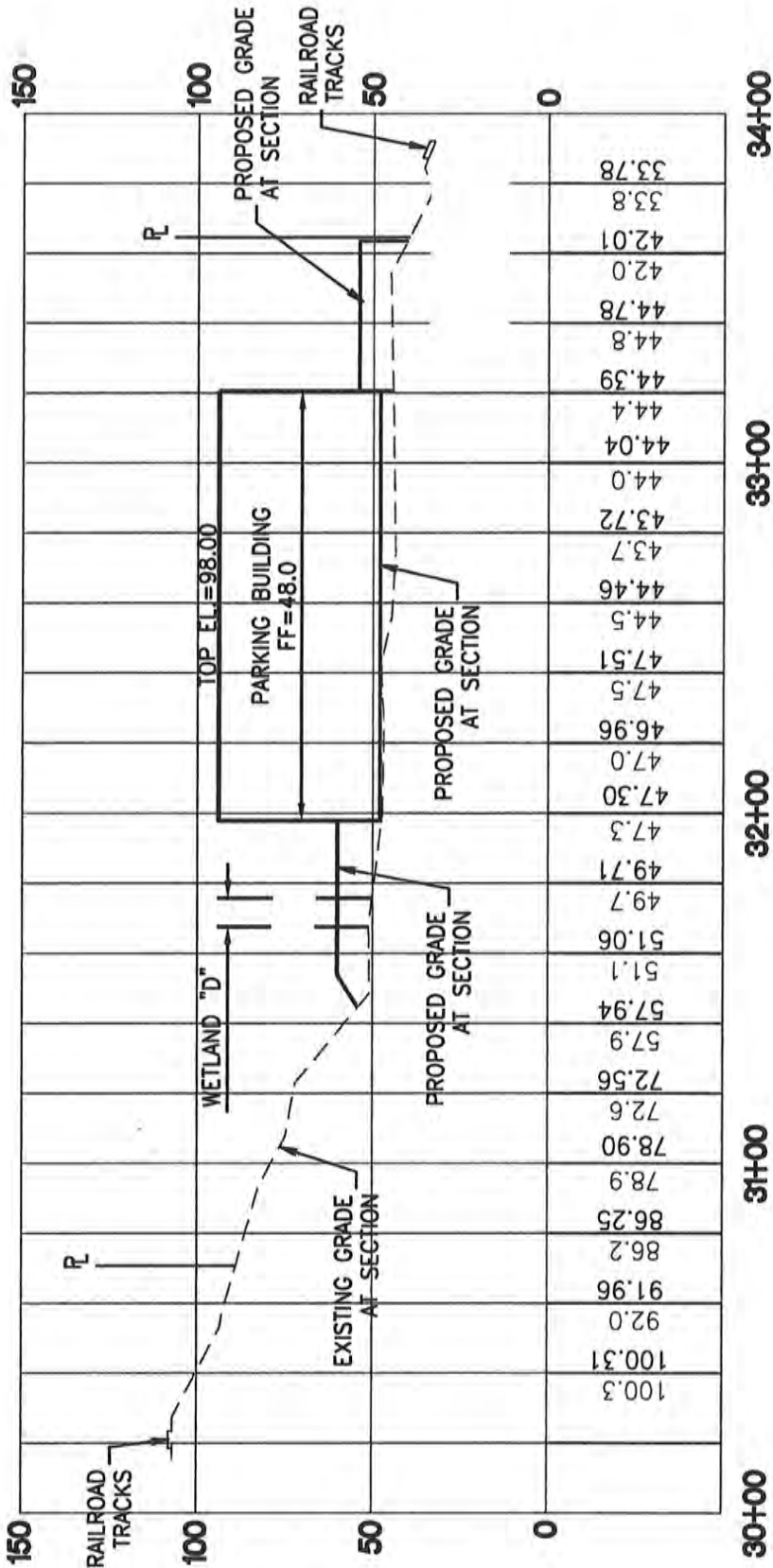

# SITE SECTION

SCALE: H: 1"=50' V: 1"=50'



NOTE: SECTIONS PROVIDED BY BARGHAUSEN ENGINEERS



**TALASAEA CONSULTANTS, INC.**  
Resource & Environmental Planning  
15020 Bear Creek Road Northeast  
Woodinville, Washington 98077  
Bus (425)861-7550 - Fax (425)861-7549

FIGURE TITLE: SECTION B  
DRAWN: ABS  
TAL# 1467  
LAT. & LONG. 47.1203, -122.1515  
DATE: 9-9-2014  
REVISED: 1-29-2015  
FIGURE # 10 OF 11

REFERENCE: NWS-2014-0283  
APPLICANT: ASTRONICS AES CORPORATION  
PROPOSED PROJECT: ASTRONICS EXPANSION  
PURPOSE: OFFICE & MFG. FACILITY EXPANSION  
ADDRESS: 12450 WILLOWS RD NE  
CITY: KIRKLAND COUNTY: KING STATE: WA UNNAMED WETLANDS

SE 1/4, SEC 22, TWP. 26N, RGE. 5E, WM.

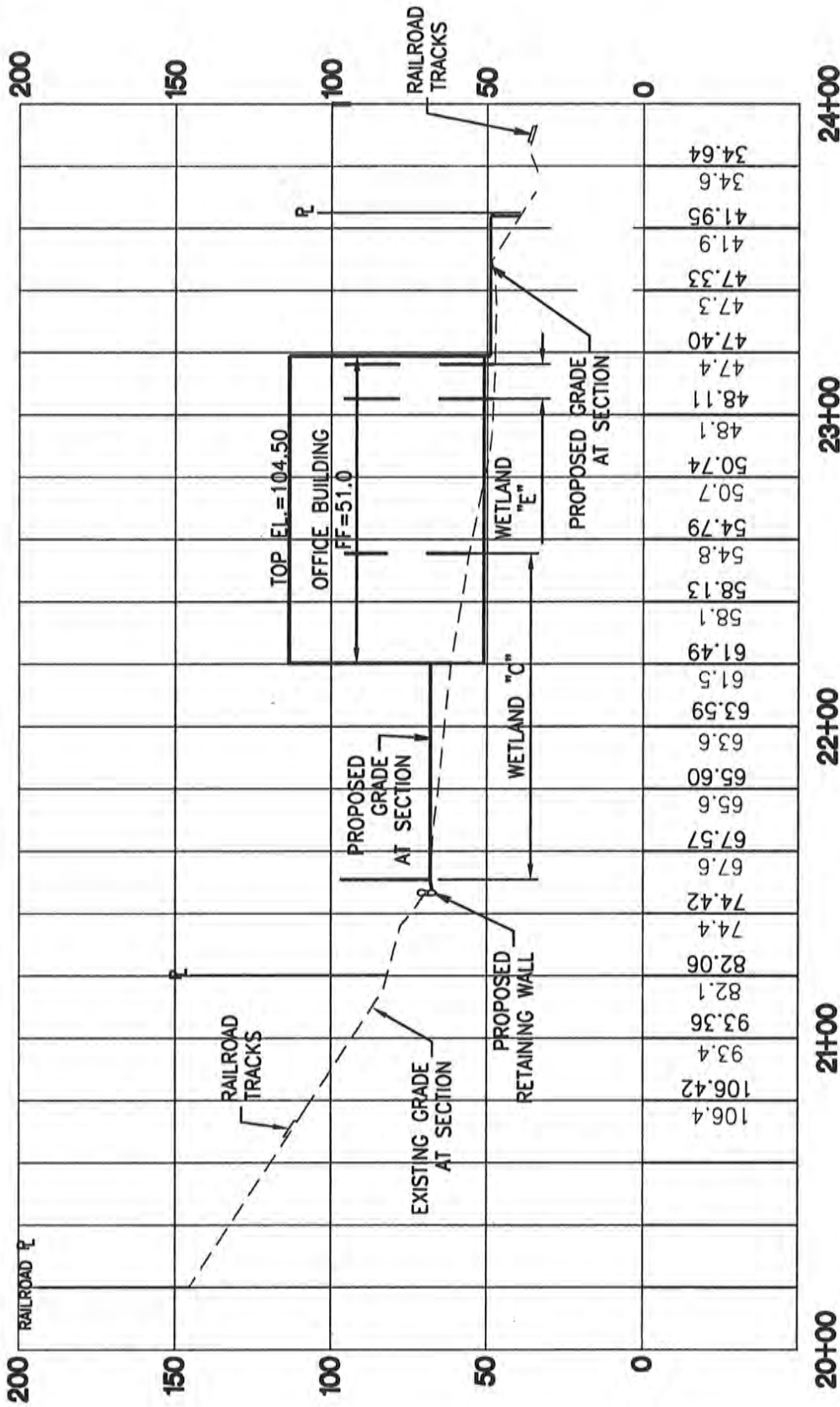

**C-C**  
4  
**SITE SECTION**

SCALE: H: 1"=50' V: 1"=50'

NOTE: SECTIONS  
PROVIDED BY  
BARGHAUSEN ENGINEERS



**TALASAEA CONSULTANTS, INC.**  
Resource & Environmental Planning  
15020 Bear Creek Road Northeast  
Woodinville, Washington 98077  
Bus (425)861-7550 - Fax (425)861-7549

FIGURE TITLE SECTION C		DRAWN ABS	TAL# 1467
REFERENCE NWS-2014-0203	APPLICANT ASTRONICS AES CORPORATION	LAT. & LONG. 47.1203, -122.1515	
PROPOSED PROJECT: ASTRONICS EXPANSION		DATE	REVISED
PURPOSE: OFFICE & MFG. FACILITY EXPANSION		9-4-2014	1-24-2015
ADDRESS: 12950 WILLOWS RD NE		FIGURE #	
CITY KIRKLAND	COUNTY KING	STATE WA	UNNAMED WETLANDS
UNNAMED WETLANDS		OF	

Z:\BARGHAUSEN\4400-1400\TALASAEA\PARASITA\DWG\146PP\ASTRONICS\2015-86g-2015.dwg © Copyright - Talasaea Consultants, INC.