



US Army Corps  
of Engineers  
Seattle District



WASHINGTON STATE  
DEPARTMENT OF  
E C O L O G Y

# Joint Public Notice

## Application for a Department of the Army Permit and a Washington Department of Ecology Water Quality Certification and/or Coastal Zone Management Consistency Concurrence

**US Army Corps of Engineers**  
Regulatory Branch  
Post Office Box 3755  
Seattle, WA 98124-3755  
Telephone: (206) 764-3450  
ATTN: Jason Sweeney,  
Project Manager

**WA Department of Ecology**  
SEA Program  
Post Office Box 47600  
Olympia, WA 98504-7600  
Telephone: (360) 407-6076  
ATTN: SEA Program,  
Federal Permit Coordinator

**Public Notice Date: August 2, 2018**  
**Expiration Date: August 31, 2018**

**Reference No.: NWS-2017-37**  
**Name: The Boeing Company (Apron  
R Maintenance)**

---

Interested parties are hereby notified that the U.S. Army Corps of Engineers (Corps) and the Washington Department of Ecology (Ecology) have received an application to perform work in waters of the U.S. as described below and shown on the enclosed drawings dated October 3, 2017.

The Corps will review the work in accordance with Section 404 of the Clean Water Act (CWA) and Section 10 of the Rivers and Harbors Act. Ecology will review the work pursuant to Section 401 of the CWA, with applicable provisions of State water pollution control laws and the Coastal Zone Management Act.

**APPLICANT:** The Boeing Company  
Attention: Mark Clement  
P.O. Box 3707, MC 1W-09  
Seattle, Washington 98124  
Telephone: (206) 617-2944

**AGENT:** Wood Environment & Infrastructure Solutions, Inc.  
Attention: Cliff Whitmus  
3500 188th Street SW, Suite 601  
Lynnwood, Washington 98037  
Telephone: (425) 921-4023

**LOCATION:** In Lake Washington at the Boeing Renton Factory, 737 Logan Avenue North, Renton, Washington

**WORK:** The proposed project would maintain, upgrade, and expand existing facilities on Apron R of the Boeing Renton Factory. The applicant is proposing to construct a new bulkhead, replace an existing bulkhead, create a designated barge berth, extend and relocate existing outfalls, and add cathodic protection to an existing flume.

The construction of the new 675 linear foot (LF) bulkhead would occur waterward of the existing western ramp overwater structure. After construction of the bulkhead is completed, 4,100 cubic yards (CY) of fill material would be placed landward of the bulkhead. This would convert 7,600 square feet (SF) of overwater coverage to uplands, and 3,165 SF of open water to uplands for a permanent loss of 10,765 SF of waters of the U.S.

## **NWS-2017-37, The Boeing Company (Apron R Maintenance)**

To access and replace the existing bulkhead, 3,220 SF of an overwater structure would be removed. A sheet pile wall would be installed up to four feet waterward along the 500 LF of existing bulkhead, and the area in between dewatered. The existing bulkhead would then be removed and up to 445 CY of fill material placed in between the sheet pile wall and uplands. This would result in the permanent loss of up to 2,000 SF of waters of the U.S.

Two new 36-inch diameter steel piles would be installed for barge mooring and located along a 140 LF section of the newly installed sheet pile wall.

Relocating and extending existing outfalls would require the excavation of up to 155 CY of lake bed sediment, and the placement of up to 22 CY of gravel as lake bed preparation over an area up to 700 SF.

**PURPOSE:** To provide continued, long-term operations at the Boeing Renton Factory.

**ADDITIONAL INFORMATION:** Boeing allows a 10 day shutdown of production during the winter holidays (typically December 24 through January 3). Completion of the proposed project during the holiday closure is not possible, nor can it be accomplished during the in-water work windows. Phasing of the proposed project has been designed to allow Boeing to complete the proposed project, as well as, maintain production schedules while minimizing the effects to Endangered Species Act (ESA) listed species. The applicant has proposed to work up to 14 days past each authorized in-water work window during the three years of construction.

Up to 900 piles would either be extracted or driven below the mud line during the demolition of the existing overwater structures. All pile driving and removal would be conducted with a vibratory pile driver as possible, no impact pile driving is proposed.

The applicant is also proposing upland improvements, including constructing storm water retention and treatment facilities.

The location of the ordinary high water mark shown on the project drawings have not yet been verified by the Corps. If the Corps determines the boundaries of the wetland/waters are substantially inaccurate a new public notice may be published.

**MITIGATION:** As compensatory mitigation the applicant is proposing to place up to 5,160 CY of fill material waterward of the ordinary high watermark to create terrestrial and aquatic habitat along the shoreline in front of the new and existing bulkheads. The applicant is also proposing to enhance and create riparian habitat by removing invasive species, and replacing with native vegetation, as well as adding native vegetation where none is present along the upland shoreline of Lake Washington.

**ENDANGERED SPECIES:** The ESA requires federal agencies to consult with the National Marine Fisheries Service (NMFS) and/or U.S. Fish and Wildlife Service (USFWS) pursuant to Section 7 of the ESA on all actions that may affect a species listed (or proposed for listing) under the ESA as threatened or endangered or any designated critical habitat.

After receipt of comments from this public notice, the Corps will evaluate the potential impacts to proposed and/or listed species and their designated critical habitat.

**ESSENTIAL FISH HABITAT:** The Magnuson-Stevens Fishery Conservation and Management Act, as amended by the Sustainable Fisheries Act of 1996, requires all Federal agencies to consult with the NMFS on all actions, or proposed actions, permitted, funded, or undertaken by the agency, that may adversely affect Essential Fish Habitat (EFH). The proposed action would impact EFH in the project area.

## **NWS-2017-37, The Boeing Company (Apron R Maintenance)**

If the Corps determines that the proposed action may adversely affect EFH for federally managed fisheries in Washington waters, the Corps will initiate EFH consultation with the NMFS. The Corps' final determination relative to project impacts and the need for mitigation measures is subject to review by and coordination with the NMFS.

**CULTURAL RESOURCES:** The Corps has reviewed the latest published version of the National Register of Historic Places, Washington Information System for Architectural and Archaeological Records Data and other sources of information. There are no recorded historic properties within the permit area. The permit area has been so extensively disturbed by modern development that little likelihood exists for the proposed project to impinge upon an undisturbed historic property. The Corps invites responses to this public notice from Native American Tribes or tribal governments; Federal, State, and local agencies; historical and archeological societies; and other parties likely to have knowledge of or concerns regarding historic properties and sites of religious and cultural significance at or near the project area. After receipt of comments from this public notice, the Corps will evaluate potential impacts and consult with the State Historic Preservation Officer and Native American Tribes in accordance with Section 106 of the National Historic Preservation Act, as appropriate.

**EVALUATION – CORPS:** The decision whether to issue a permit will be based on an evaluation of the probable impacts, including cumulative impacts, of the proposed activity on the public interest. That decision will reflect the national concern for both protection and utilization of important resources. The benefits, which reasonably may be expected to accrue from the proposal, must be balanced against its reasonably foreseeable detriments. All factors which may be relevant to the proposal will be considered, including the cumulative effects thereof; among those are conservation, economics, aesthetics, general environmental concerns, wetlands, historic properties, fish and wildlife values, flood hazards, floodplain values, land use, navigation, shoreline erosion and accretion, recreation, water supply and conservation, water quality, energy needs, safety, food and fiber production, mineral needs, considerations of property ownership, and, in general, the needs and welfare of the people.

The Corps is soliciting comments from the public; Native American Nations or tribal governments; Federal, State, and local agencies and officials; and other interested parties in order to consider and evaluate the impacts of this activity. Any comments received will be considered by the Corps to determine whether to issue, modify, condition or deny a permit for the work. To make this decision, comments are used to assess impacts on endangered species, historic properties, water quality, general environmental effects, and the other public interest factors listed above. Comments are used in the preparation of an Environmental Assessment and/or an Environmental Impact Statement pursuant to the National Environmental Policy Act. Comments are also used to determine the need for a public hearing and to determine the overall public interest of the activity.

The described discharge will be evaluated for compliance with guidelines promulgated by the Environmental Protection Agency under authority of Section 404(b)(1) of the CWA. These guidelines require an alternatives analysis for any proposed discharge of dredged or fill material into waters of the United States.

**SOURCE OF FILL MATERIAL:** The applicant has not yet identified the source of the fill material. Should a permit be issued, the Corps will evaluate the fill material source prior to the start of construction.

**EVALUATION – ECOLOGY:** Ecology is soliciting comments from the public; Federal, Native American Nations or tribal governments, State, and local agencies and officials; and other interested parties in order to consider and evaluate the impacts of this activity. Ecology will be considering all comments to determine whether to certify or deny certification for the proposed project.

**ADDITIONAL EVALUATION:** This proposal is the subject of Shorelines Substantial Development Permit No. LUA17-000631 which has been issued by City of Renton.

**NWS-2017-37, The Boeing Company (Apron R Maintenance)**

COMMENT AND REVIEW PERIOD: Conventional mail or e-mail comments on this public notice will be accepted and made part of the record and will be considered in determining whether authorizing the work would not be contrary to the public interest. In order to be accepted, e-mail comments must originate from the author's e-mail account and must include on the subject line of the e-mail message the permit applicant's name and reference number as shown below. Either conventional mail or e-mail comments must include the permit applicant's name and reference number, as shown below, and the commenter's name, address, and phone number. All comments whether conventional mail or e-mail must reach this office, no later than the expiration date of this public notice to ensure consideration.

CORPS COMMENTS: All e-mail comments should be sent to [jason.t.sweeney@usace.army.mil](mailto:jason.t.sweeney@usace.army.mil). Conventional mail comments should be sent to: U.S. Army Corps of Engineers, Regulatory Branch, Attention: Jason Sweeney, P.O. Box 3755, Seattle, Washington 98124-3755. All comments received will become part of the administrative record and are subject to public release under the Freedom of Information Act including any personally identifiable information such as names, phone numbers, and addresses.

ECOLOGY COMMENTS: Any person desiring to present views on the project pertaining to a request for water quality certification under Section 401 of the CWA and/or Coastal Zone Management consistency concurrence, may do so by submitting written comments to the following address: Washington State Department of Ecology, Attention: Federal Permit Coordinator, Post Office Box 47600, Olympia, Washington 98504-7600, or e-mail to [ecyrefedpermits@ecy.wa.gov](mailto:ecyrefedpermits@ecy.wa.gov).

To ensure proper consideration of all comments, responders must include the following name and reference number in the text of their comments: The Boeing Company (Apron R Maintenance); NWS-2017-37

Encl: Figures (17)



VICINITY MAP  
SCALE: 1"=1200'

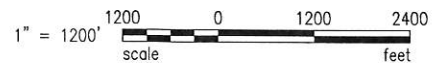

PURPOSE: APRON R INFRASTRUCTURE IMPROVEMENTS

DATUM: NAVD 88

ADJACENT PROPERTY OWNERS:  
WDNR, CITY OF RENTON, SOUTHPORT LLC,  
HOTEL AT SOUTHPORT LLC

NAME: THE BOEING COMPANY

SITE LOCATION ADDRESS:  
THE BOEING COMPANY  
737 LOGAN AVE. N.  
RENTON, WA 98055

REFERENCE NUMBER: NWS-2017-37

IN: LAKE WASHINGTON  
NEAR/AT: RENTON  
COUNTY: KING

STATE: WA

SHEET: 1 OF 17



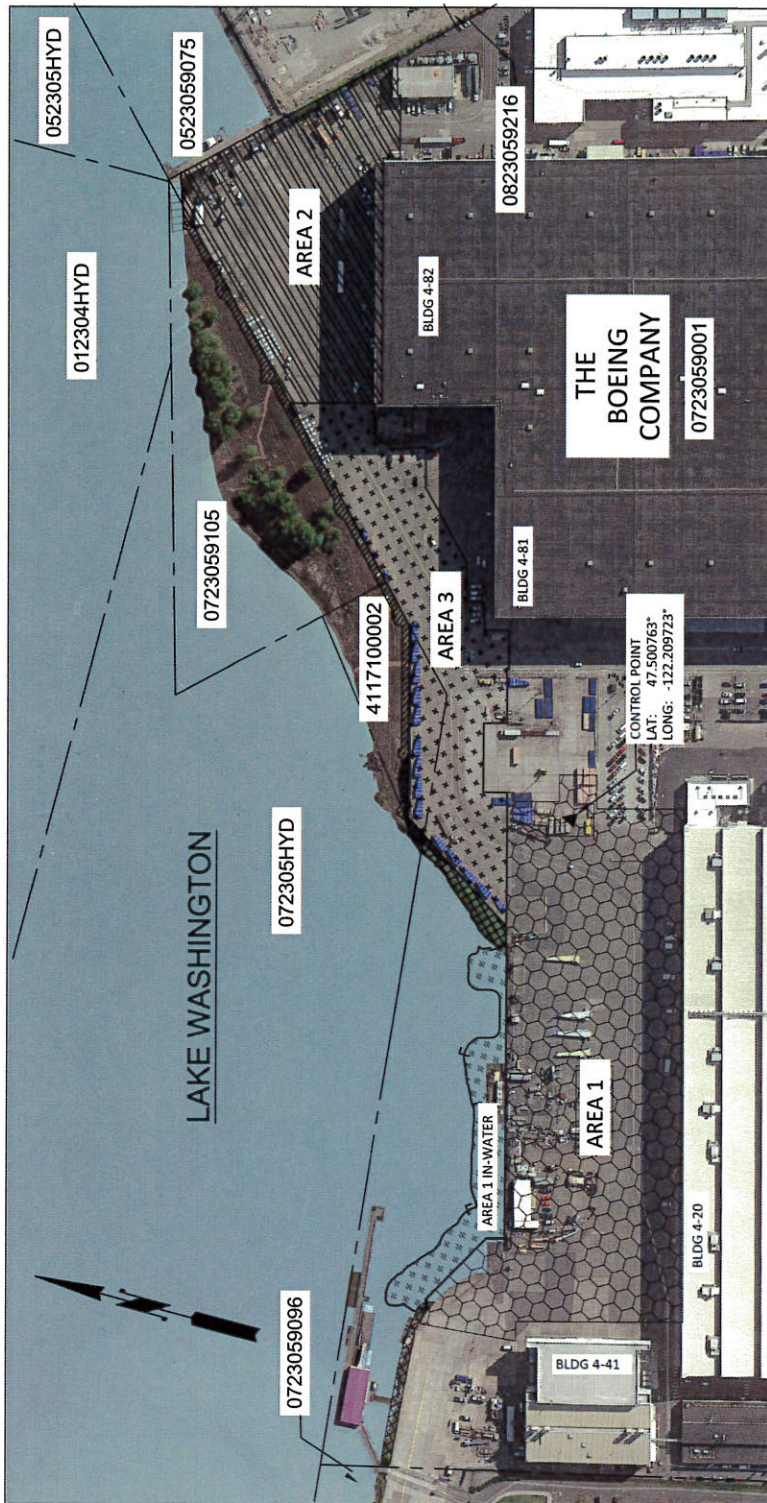



DATE: 10/3/17



**PROJECT AREA PLAN**

SCALE: 1"=400'

**LEGEND**

-  AREA 1 - ANTICIPATED CONSTRUCTION DATES: 6/2018 TO 4/2019
-  AREA 1 IN-WATER - ANTICIPATED CONSTRUCTION DATES: SUMMER AND WINTER 2018 IN-WATER WORK WINDOWS
-  AREA 2 - ANTICIPATED IN-WATER CONSTRUCTION DATES: SUMMER/WINTER 2019 WORK WINDOWS; UPLAND CONSTRUCTION: 3/2019 TO 10/2019
-  AREA 3 - ANTICIPATED IN-WATER CONSTRUCTION DATES: SUMMER/WINTER 2019 WORK WINDOWS; UPLAND CONSTRUCTION: 7/2019 TO 1/2020
-  INVASIVE SPECIES REMOVAL - ANTICIPATED CONSTRUCTION DATES CORRESPOND WITH THE AREA 1 IN-WATER WORK
-  DNR UTILITY EASEMENT - ANTICIPATED CONSTRUCTION DATES THROUGHOUT THE PROJECT

Parcel Number	Taxpayer Name
0523059075	HOTEL AT SOUTHPORT LLC
0723059001	BOEING COMPANY
0723059096	CITY OF RENTON
0723059105	DEPT OF NATURAL RESOURCES
0823059216	SOUTHPORT LLC
4117100002	DEPT OF NATURAL RESOURCES
072305HYD	DEPT OF NATURAL RESOURCES
012304HYD	DEPT OF NATURAL RESOURCES
052305HYD	DEPT OF NATURAL RESOURCES

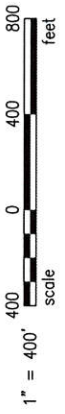

PURPOSE: APRON R INFRASTRUCTURE IMPROVEMENTS

DATUM: NAVD 88

ADJACENT PROPERTY OWNERS:  
WDNR, CITY OF RENTON, SOUTHPORT LLC,  
HOTEL AT SOUTHPORT LLC

NAME: THE BOEING COMPANY

SITE LOCATION ADDRESS:  
THE BOEING COMPANY  
737 LOGAN AVE. N.  
RENTON, WA 98055

REFERENCE NUMBER: NWS-2017-37

IN: LAKE WASHINGTON  
NEAR/AT: RENTON  
COUNTY: KING STATE: WA

SHEET: 2 OF 17

DATE: 10/3/17

# LAKE WASHINGTON

## LEGEND

-  PERMANENT STRUCTURAL FILL
-  AREA 1 APRON R PAVEMENT REPLACEMENT
-  INVASIVE SPECIES REMOVAL
-  DNR UTILITY EASEMENT REMOVAL

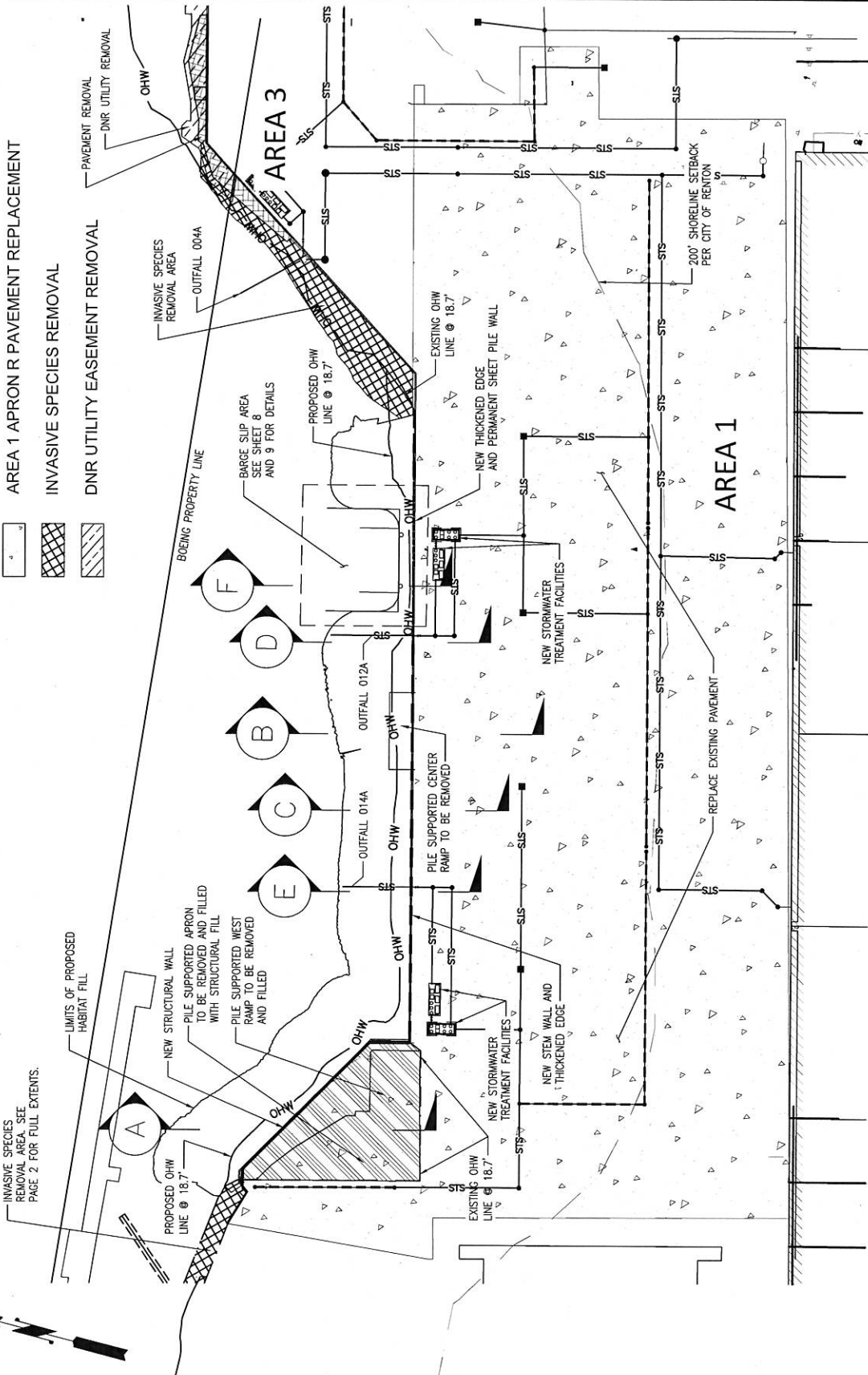

# 1 AREA 1 PROPOSED IMPROVEMENTS PLAN

SCALE: 1"=60' DATUM: NAVD 88

PURPOSE: APRON R INFRASTRUCTURE IMPROVEMENTS

DATUM: NAVD 88

ADJACENT PROPERTY OWNERS:  
WDNR, CITY OF RENTON, SOUTHPORT LLC,  
HOTEL AT SOUTHPORT LLC

NAME: THE BOEING COMPANY

SITE LOCATION ADDRESS:  
THE BOEING COMPANY  
737 LOGAN AVE. N.  
RENTON, WA 98055

REFERENCE NUMBER: NWS-2017-37

IN: LAKE WASHINGTON  
NEAR/AT: RENTON  
COUNTY: KING

STATE: WA

SHEET: 3 OF 17

DATE: 10/3/17

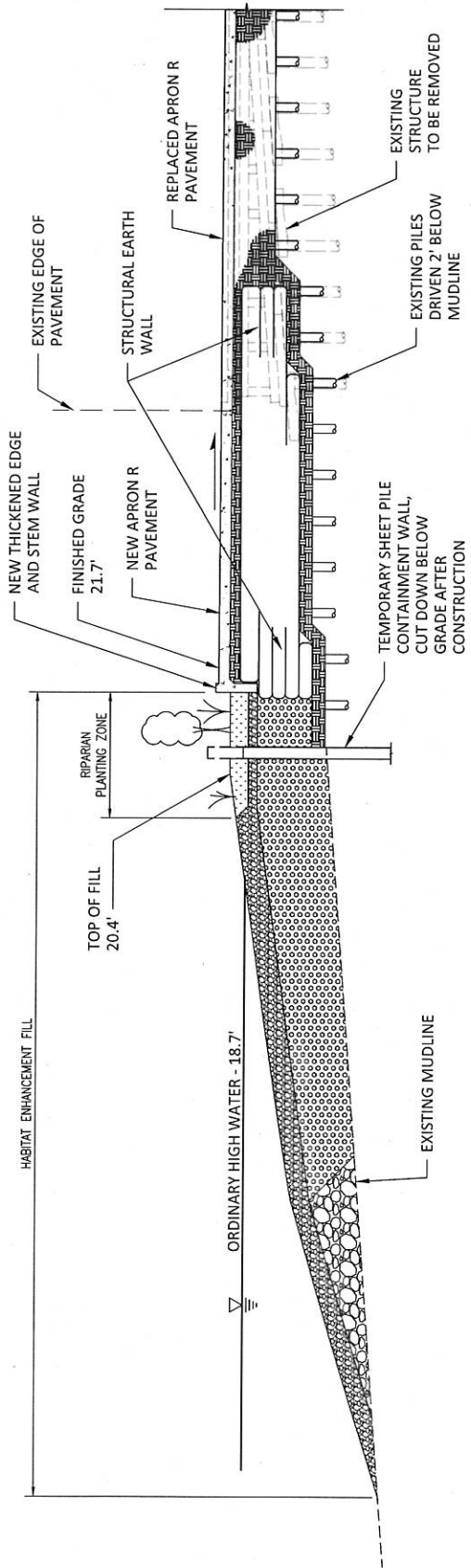

**AREA 1 SECTION A - WEST RAMP**  
 SCALE: 1"=10' DATUM: NAVD 88

**LEGEND**

- STRUCTURAL FILL
- HABITAT ENHANCEMENT FILL
- PLANTING SOIL MIX
- 6" STREAMBED COBBLES
- ROCK FOR EROSION AND SCOUR PROTECTION CLASS A
- ROCK FOR EROSION AND SCOUR PROTECTION CLASS B

DATUM	NAVD 88	NGVD 29	C.O.E.
OHW	18.7'	15.1'	21.9'



PURPOSE: APRON R INFRASTRUCTURE IMPROVEMENTS  
 DATUM: NAVD 88  
 ADJACENT PROPERTY OWNERS:  
 WDNR, CITY OF RENTON, SOUTHPORT LLC,  
 HOTEL AT SOUTHPORT LLC

NAME: THE BOEING COMPANY  
 SITE LOCATION ADDRESS:  
 THE BOEING COMPANY  
 737 LOGAN AVE. N.  
 RENTON, WA 98055

REFERENCE NUMBER: NWS-2017-37  
 IN: LAKE WASHINGTON  
 NEAR/AT: RENTON  
 COUNTY: KING STATE: WA  
 SHEET: 4 OF 17  
 DATE: 10/3/17



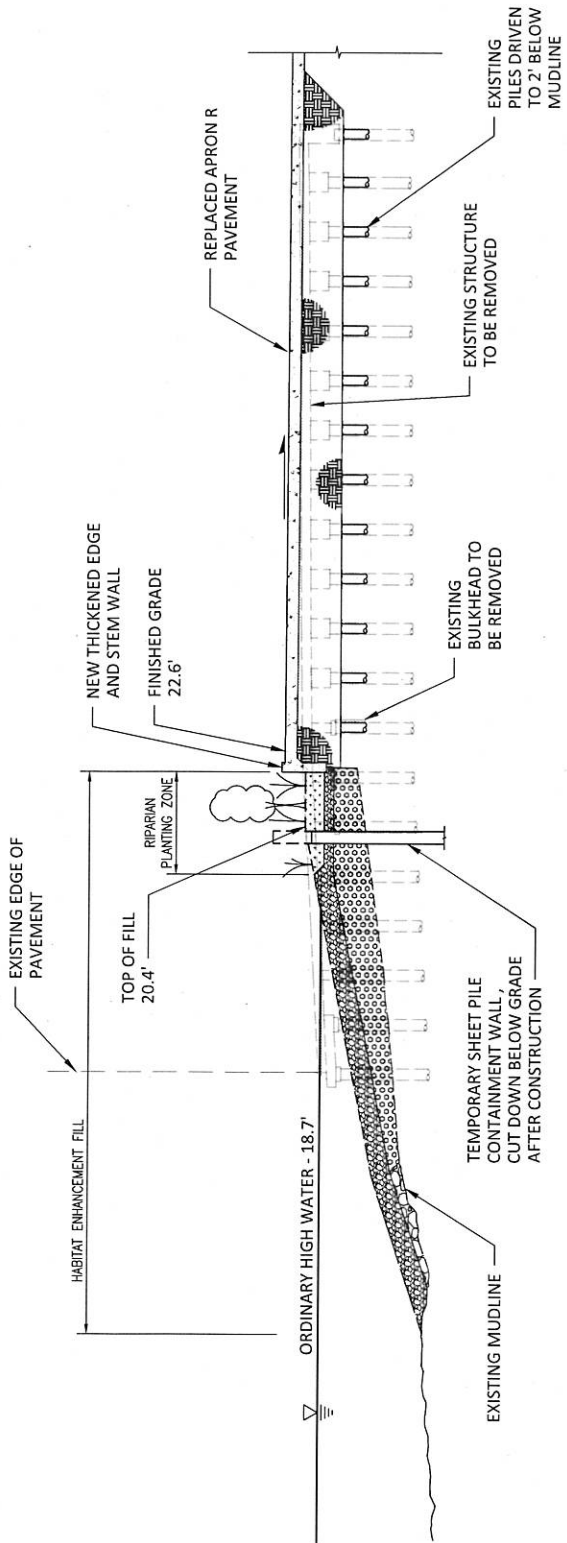







### AREA 1 SECTION B - CENTRAL RAMP

SCALE: 1"=10' DATUM: NAVD 88

#### LEGEND

-  STRUCTURAL FILL
-  HABITAT ENHANCEMENT FILL
-  PLANTING SOIL MIX
-  6" STREAMBED COBBLES
-  ROCK FOR EROSION AND SCOUR PROTECTION CLASS A
-  ROCK FOR EROSION AND SCOUR PROTECTION CLASS B

DATUM	NAVD 88	NGVD 29	C.O.E.
OHW	18.7'	15.1'	21.9'



PURPOSE: APRON R INFRASTRUCTURE IMPROVEMENTS  
 DATUM: NAVD 88

ADJACENT PROPERTY OWNERS:  
 WDNR, CITY OF RENTON, SOUTHPORT LLC,  
 HOTEL AT SOUTHPORT LLC

NAME: THE BOEING COMPANY  
 SITE LOCATION ADDRESS:  
 THE BOEING COMPANY  
 737 LOGAN AVE. N.  
 RENTON, WA 98055

REFERENCE NUMBER: NWS-2017-37  
 IN: LAKE WASHINGTON  
 NEAR/AT: RENTON  
 COUNTY: KING STATE: WA  
 SHEET: 5 OF 17  
 DATE: 10/3/17

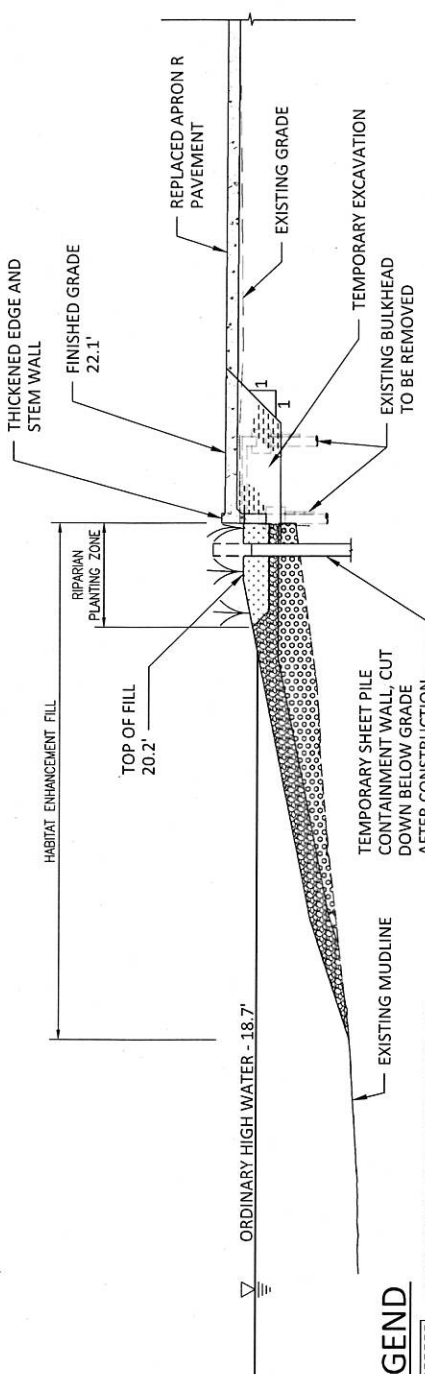

**LEGEND**

- EXCAVATION AND STRUCTURAL FILL
- HABITAT ENHANCEMENT FILL
- PLANTING SOIL MIX
- HABITAT GRAVEL
- ROCK FOR EROSION AND SCOUR PROTECTION CLASS A
- ROCK FOR EROSION AND SCOUR PROTECTION CLASS B

**AREA 1 SECTION C - BULKHEAD**

SCALE: 1"=10' DATUM: NAVD 88

DATUM	NAVD 88	NGVD 29	C.O.E.
OHW	18.7'	15.1'	21.9'

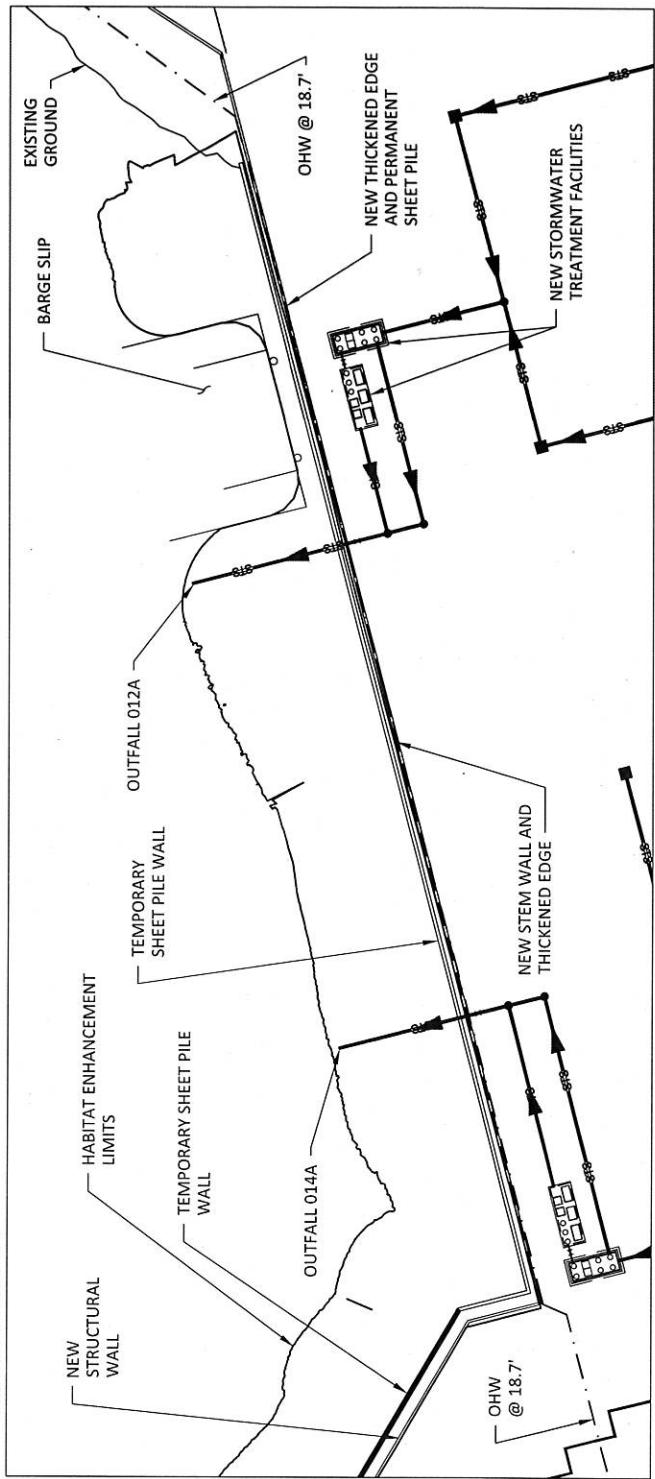

**PLAN TEMPORARY SHEET PILE**

DATUM: NAVD 88

PURPOSE: APRON R INFRASTRUCTURE IMPROVEMENTS  
 DATUM: NAVD 88  
 ADJACENT PROPERTY OWNERS:  
 WDNR, CITY OF RENTON, SOUTHPORT LLC,  
 HOTEL AT SOUTHPORT LLC

NAME: THE BOEING COMPANY  
 SITE LOCATION ADDRESS:  
 THE BOEING COMPANY  
 737 LOGAN AVE. N.  
 RENTON, WA 98055

REFERENCE NUMBER: NWS-2017-37  
 IN: LAKE WASHINGTON  
 NEAR/AT: RENTON  
 COUNTY: KING STATE: WA  
 SHEET: 6 OF 17  
 DATE: 10/3/17

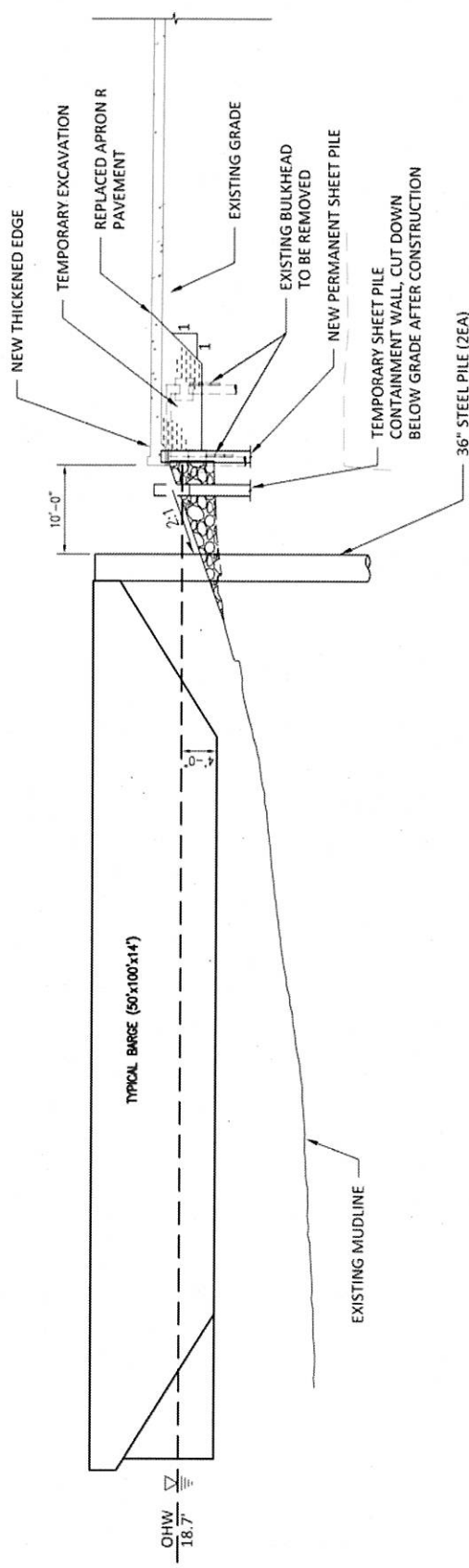

**AREA 1 SECTION F - BARGE SLIP**

SCALE: 1"=10' DATUM: NAVD 88

DATUM	NAVD 88	NGVD 29	C.O.E.
OHW	18.7'	15.1'	21.9'

**LEGEND**

- HABITAT ENHANCEMENT FILL
- ROCK FOR EROSION AND SCOUR PROTECTION CLASS B
- EXCAVATION AND STRUCTURAL FILL

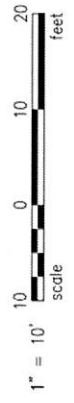

PURPOSE: APRON R INFRASTRUCTURE IMPROVEMENTS

DATUM: NAVD 88

ADJACENT PROPERTY OWNERS:  
WDNR, CITY OF RENTON, SOUTHPORT LLC,  
HOTEL AT SOUTHPORT LLC

NAME: THE BOEING COMPANY

SITE LOCATION ADDRESS:  
THE BOEING COMPANY  
737 LOGAN AVE. N.  
RENTON, WA 98055

REFERENCE NUMBER: NWS-2017-37

IN: LAKE WASHINGTON  
NEAR/AT: RENTON  
COUNTY: KING

STATE: WA

SHEET: 7 OF 17

DATE: 10/3/17

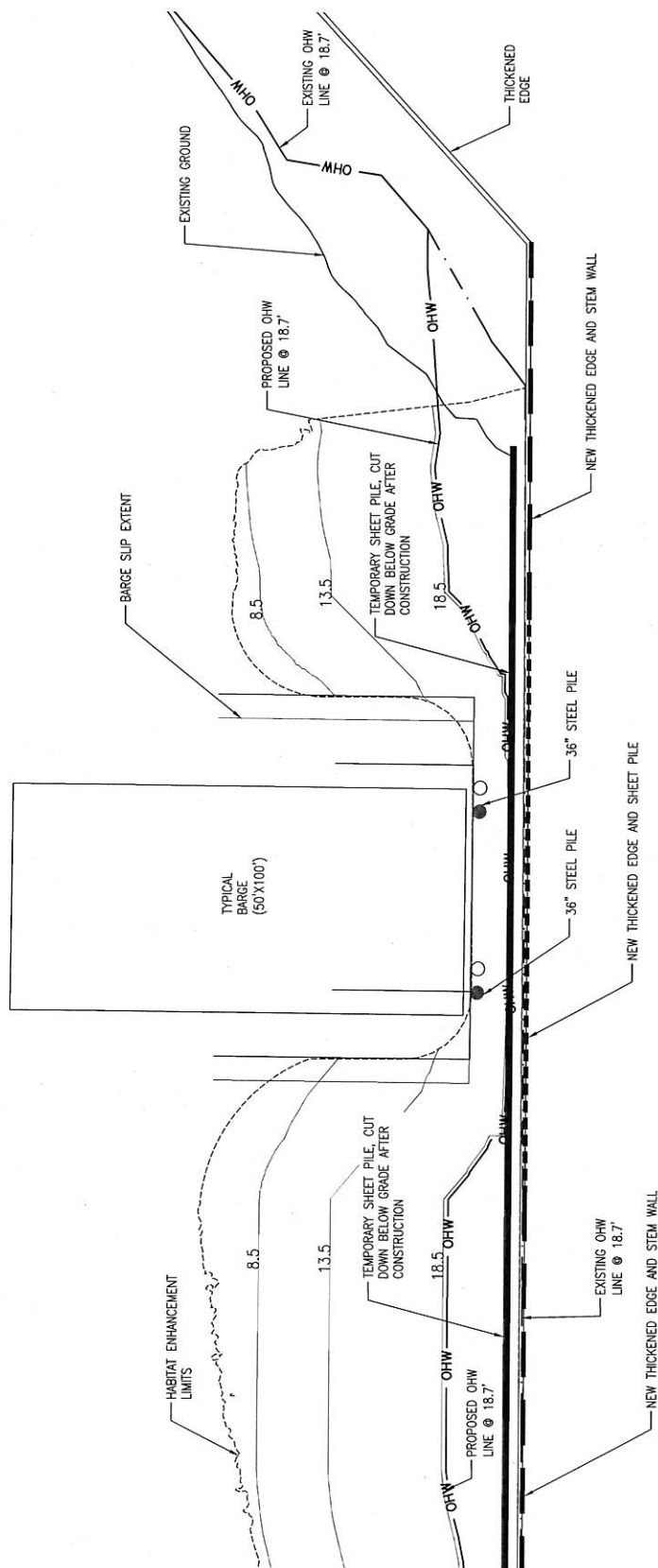

**BARGE SLIP PLAN**

SCALE: 1"=20' DATUM: NAVD 88

PURPOSE: APRON R INFRASTRUCTURE IMPROVEMENTS

DATUM: NAVD 88

ADJACENT PROPERTY OWNERS:  
 WDNR, CITY OF RENTON, SOUTHPORT LLC,  
 HOTEL AT SOUTHPORT LLC

NAME: THE BOEING COMPANY

SITE LOCATION ADDRESS:  
 THE BOEING COMPANY  
 737 LOGAN AVE. N.  
 RENTON, WA 98055

REFERENCE NUMBER: NWS-2017-37

IN: LAKE WASHINGTON  
 NEAR/AT: RENTON  
 COUNTY: KING

STATE: WA

SHEET: 8 OF 17

DATE: 10/3/17

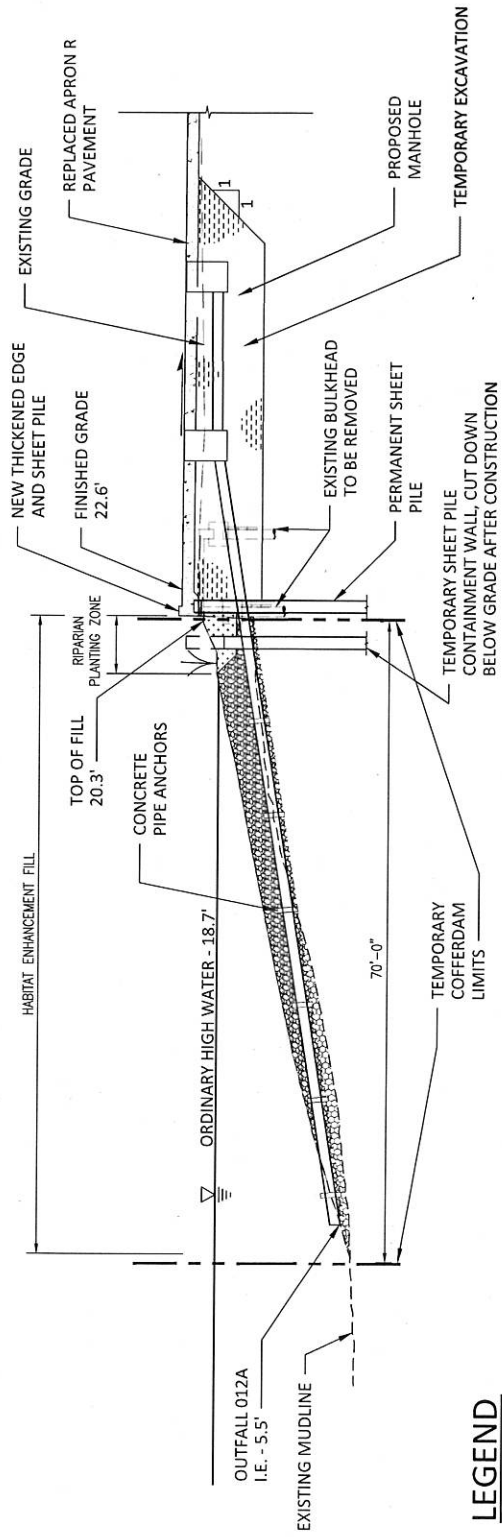

DATUM	NAVD 88	NGVD 29	C.O.E.
OHW	18.7'	15.1'	21.9'

**AREA 1 SECTION D - OUTFALL 012A**  
SCALE: 1"=10' DATUM: NAVD 88

- LEGEND**
- EXCAVATION AND STRUCTURAL FILL
  - COFFERDAM FOOTPRINT
  - HABITAT ENHANCEMENT FILL
  - PLANTING SOIL MIX
  - 6" STREAMBED COBBLES
  - QUARRY SPALLS

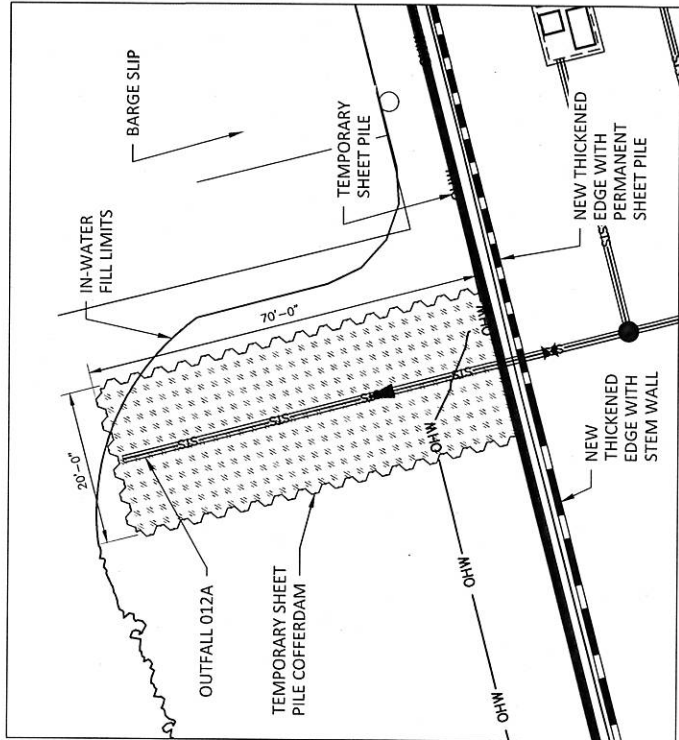

**PLAN OUTFALL 012A**  
DATUM: NONE

PURPOSE: APRON R INFRASTRUCTURE IMPROVEMENTS  
DATUM: NAVD 88

ADJACENT PROPERTY OWNERS:  
WDR, CITY OF RENTON, SOUTHPORT LLC,  
HOTEL AT SOUTHPORT LLC

NAME: THE BOEING COMPANY  
SITE LOCATION ADDRESS:  
THE BOEING COMPANY  
737 LOGAN AVE. N.  
RENTON, WA 98055

REFERENCE NUMBER: NWS-2017-37  
IN: LAKE WASHINGTON  
NEAR/AT: RENTON  
COUNTY: KING STATE: WA  
SHEET: 9 OF 17  
DATE: 10/3/17

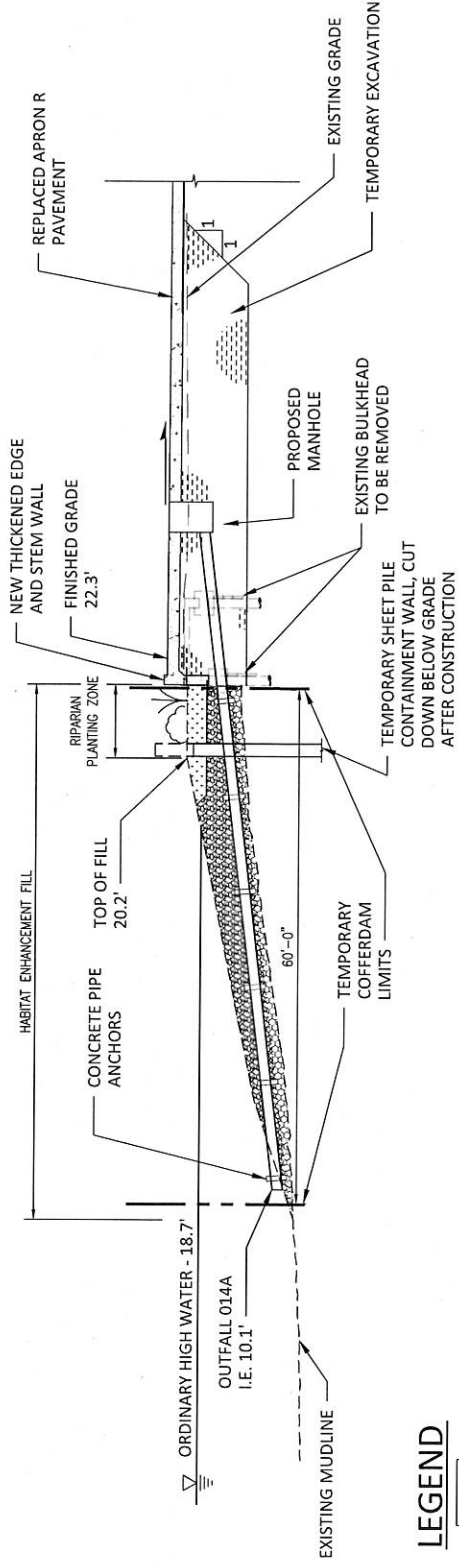

DATUM	NAVD 88	NGVD 29	C.O.E.
OHW	18.7'	15.1'	21.9'

**AREA 1 SECTION E - OUTFALL 014A**

SCALE: 1"=10' DATUM: NAVD 88

**LEGEND**

- EXCAVATION AND STRUCTURAL FILL
- COFFERDAM FOOTPRINT
- HABITAT ENHANCEMENT FILL
- PLANTING SOIL MIX
- 6" STREAMBED COBBLES
- QUARRY SPALLS

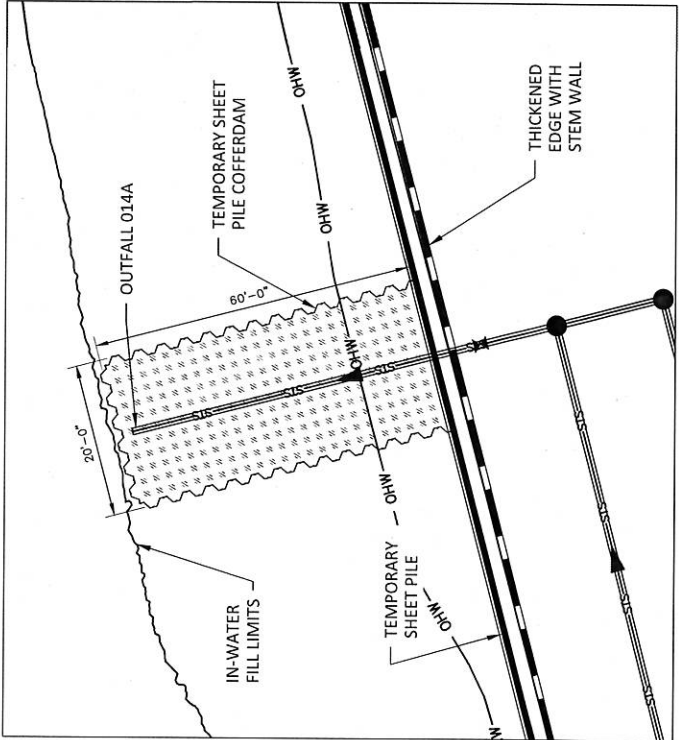

**PLAN OUTFALL 014A**

DATUM: NONE

PURPOSE: APRON R INFRASTRUCTURE IMPROVEMENTS

DATUM: NAVD 88

ADJACENT PROPERTY OWNERS:  
WDR, CITY OF RENTON, SOUTHPORT LLC,  
HOTEL AT SOUTHPORT LLC

NAME: THE BOEING COMPANY

SITE LOCATION ADDRESS:  
THE BOEING COMPANY  
737 LOGAN AVE. N.  
RENTON, WA 98055

REFERENCE NUMBER: NWS-2017-37

IN: LAKE WASHINGTON  
NEAR/AT: RENTON  
COUNTY: KING

STATE: WA

SHEET: 10 OF 17

DATE: 10/3/17

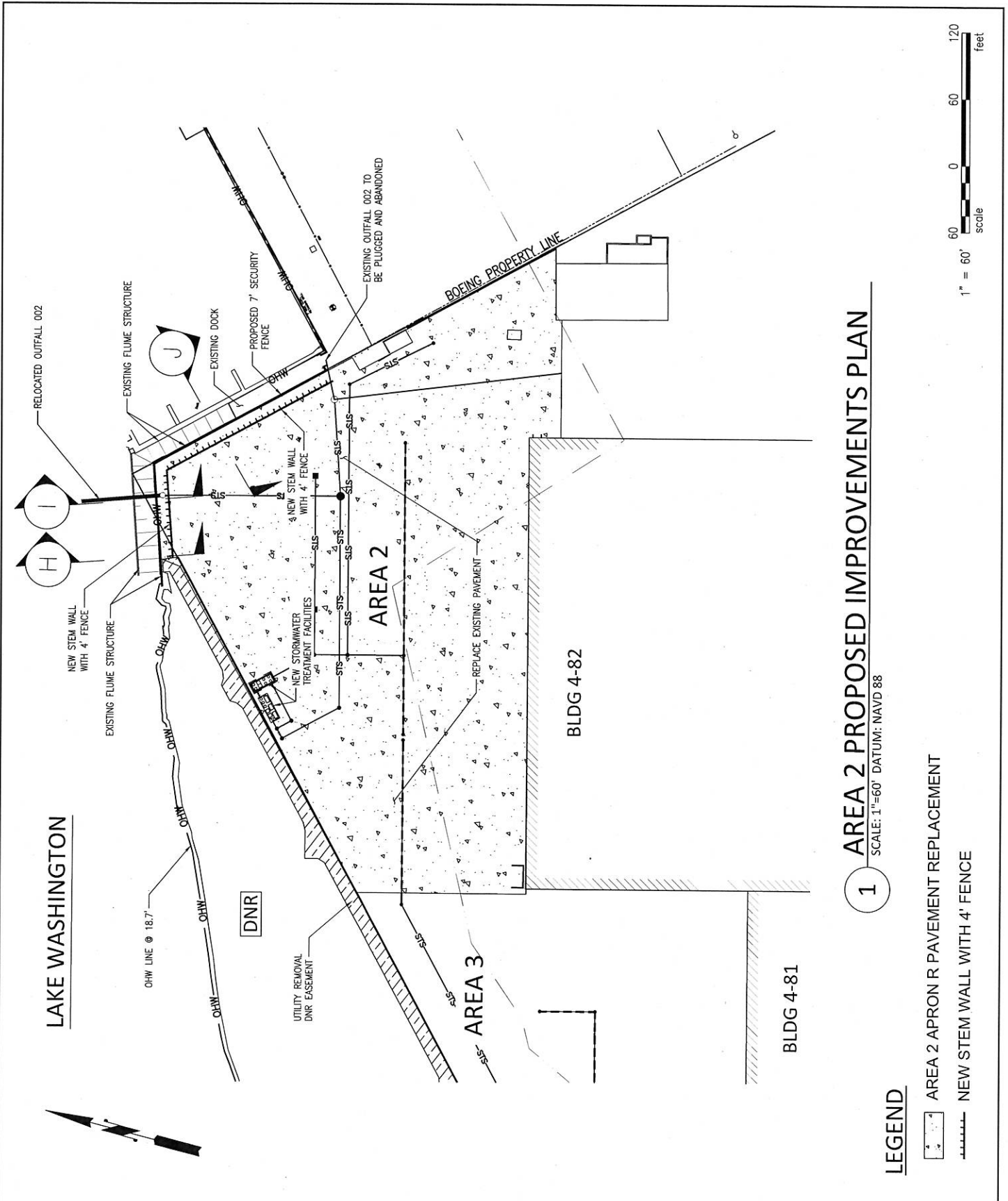

**1 AREA 2 PROPOSED IMPROVEMENTS PLAN**  
 SCALE: 1"=60' DATUM: NAVD 88

**LEGEND**

-  AREA 2 APRON R PAVEMENT REPLACEMENT
-  NEW STEM WALL WITH 4' FENCE

PURPOSE: APRON R INFRASTRUCTURE IMPROVEMENTS  
 DATUM: NAVD 88

ADJACENT PROPERTY OWNERS:  
 WDNR, CITY OF RENTON, SOUTHPORT LLC,  
 HOTEL AT SOUTHPORT LLC

NAME: THE BOEING COMPANY  
 SITE LOCATION ADDRESS:  
 THE BOEING COMPANY  
 737 LOGAN AVE. N.  
 RENTON, WA 98055

REFERENCE NUMBER: NWS-2017-37  
 IN: LAKE WASHINGTON  
 NEAR/AT: RENTON  
 COUNTY: KING STATE: WA  
 SHEET: 11 OF 17  
 DATE: 10/3/17

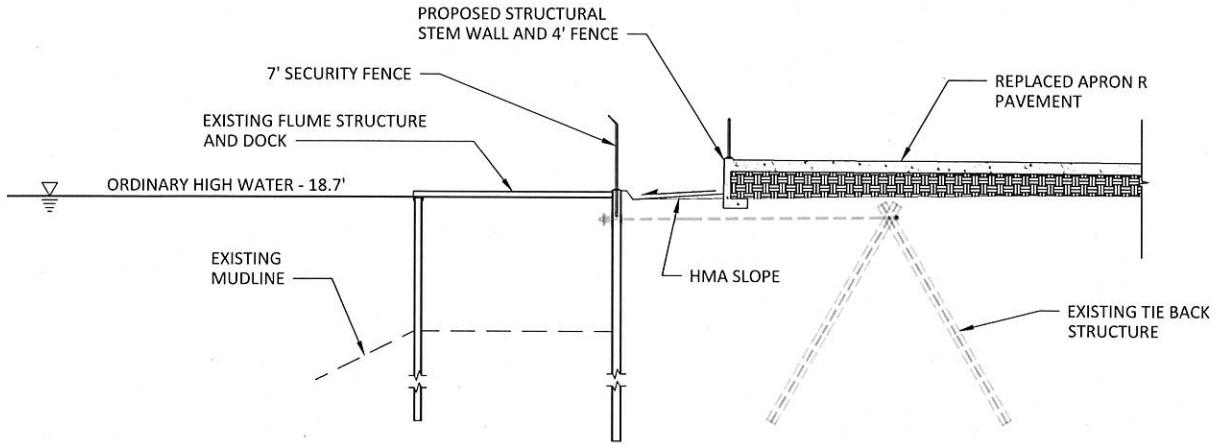

**AREA 2 SECTION J**

SCALE: 1"=10' DATUM: NAVD 88

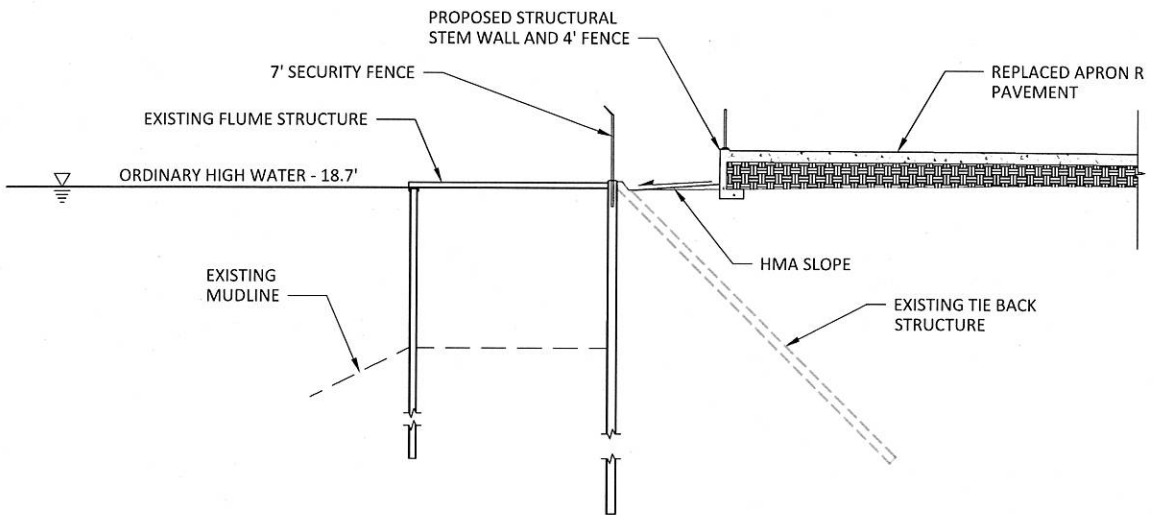

**AREA 2 SECTION H**

SCALE: 1"=10' DATUM: NAVD 88

**LEGEND**

 STRUCTURAL FILL

DATUM	NAVD 88	NGVD 29	C.O.E.
OHW	18.7'	15.1'	21.9'

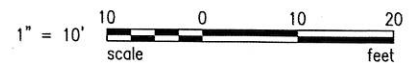

PURPOSE: APRON R INFRASTRUCTURE IMPROVEMENTS

DATUM: NAVD 88

ADJACENT PROPERTY OWNERS:  
WDNR, CITY OF RENTON, SOUTHPORT LLC,  
HOTEL AT SOUTHPORT LLC

NAME: THE BOEING COMPANY

SITE LOCATION ADDRESS:  
THE BOEING COMPANY  
737 LOGAN AVE. N.  
RENTON, WA 98055

REFERENCE NUMBER: NWS-2017-37

IN: LAKE WASHINGTON  
NEAR/AT: RENTON  
COUNTY: KING

STATE: WA

SHEET: 12 OF 17

DATE: 10/3/17



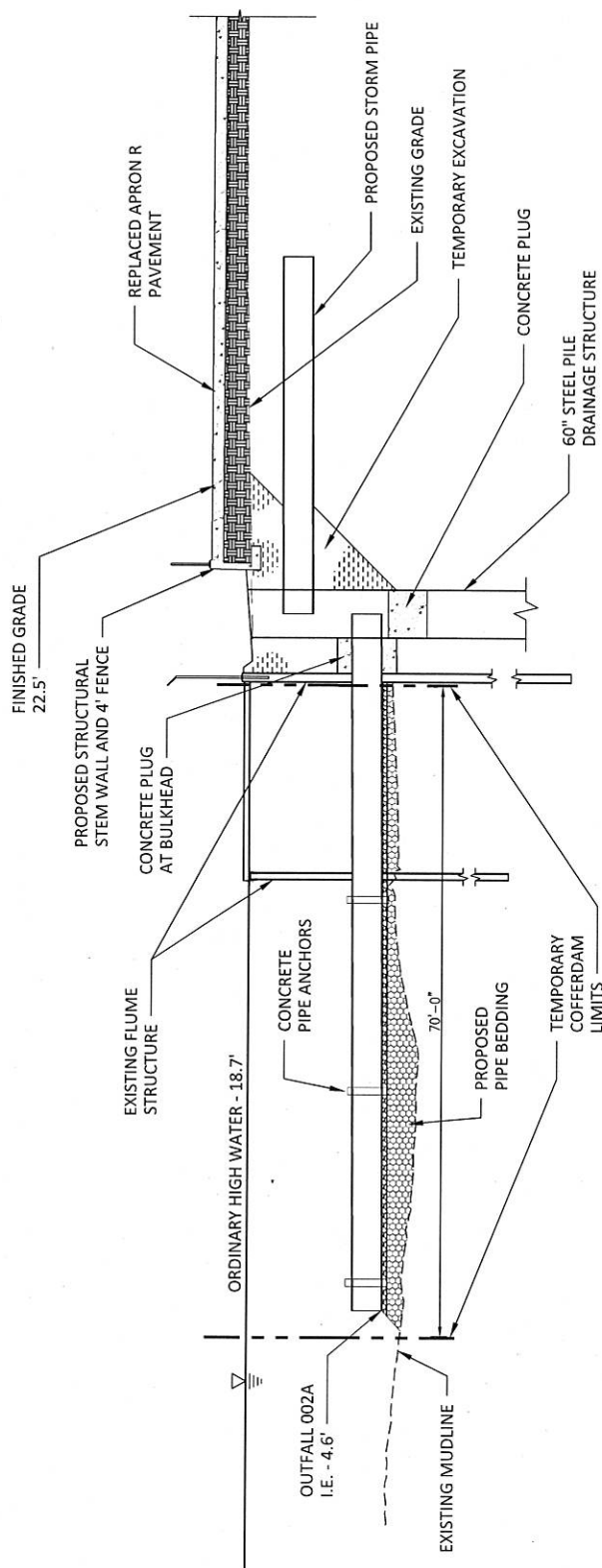

**AREA 2 SECTION I - OUTFALL 002A**

SCALE: 1"=10' DATUM: NAVD 88

**LEGEND**

- STRUCTURAL FILL
- EXCAVATION AND STRUCTURAL FILL
- QUARRY SPALLS
- 6" STREAMBED COBBLES

DATUM	NAVD 88	NGVD 29	C.O.E.
OHW	18.7'	15.1'	21.9'



PURPOSE: APRON R INFRASTRUCTURE IMPROVEMENTS

DATUM: NAVD 88

ADJACENT PROPERTY OWNERS:  
WDNR, CITY OF RENTON, SOUTHPORT LLC,  
HOTEL AT SOUTHPORT LLC

NAME: THE BOEING COMPANY

SITE LOCATION ADDRESS:  
THE BOEING COMPANY  
737 LOGAN AVE. N.  
RENTON, WA 98055

REFERENCE NUMBER: NWS-2017-37

IN: LAKE WASHINGTON  
NEAR/AT: RENTON  
COUNTY: KING

STATE: WA

SHEET: 13 OF 17

DATE: 10/3/17

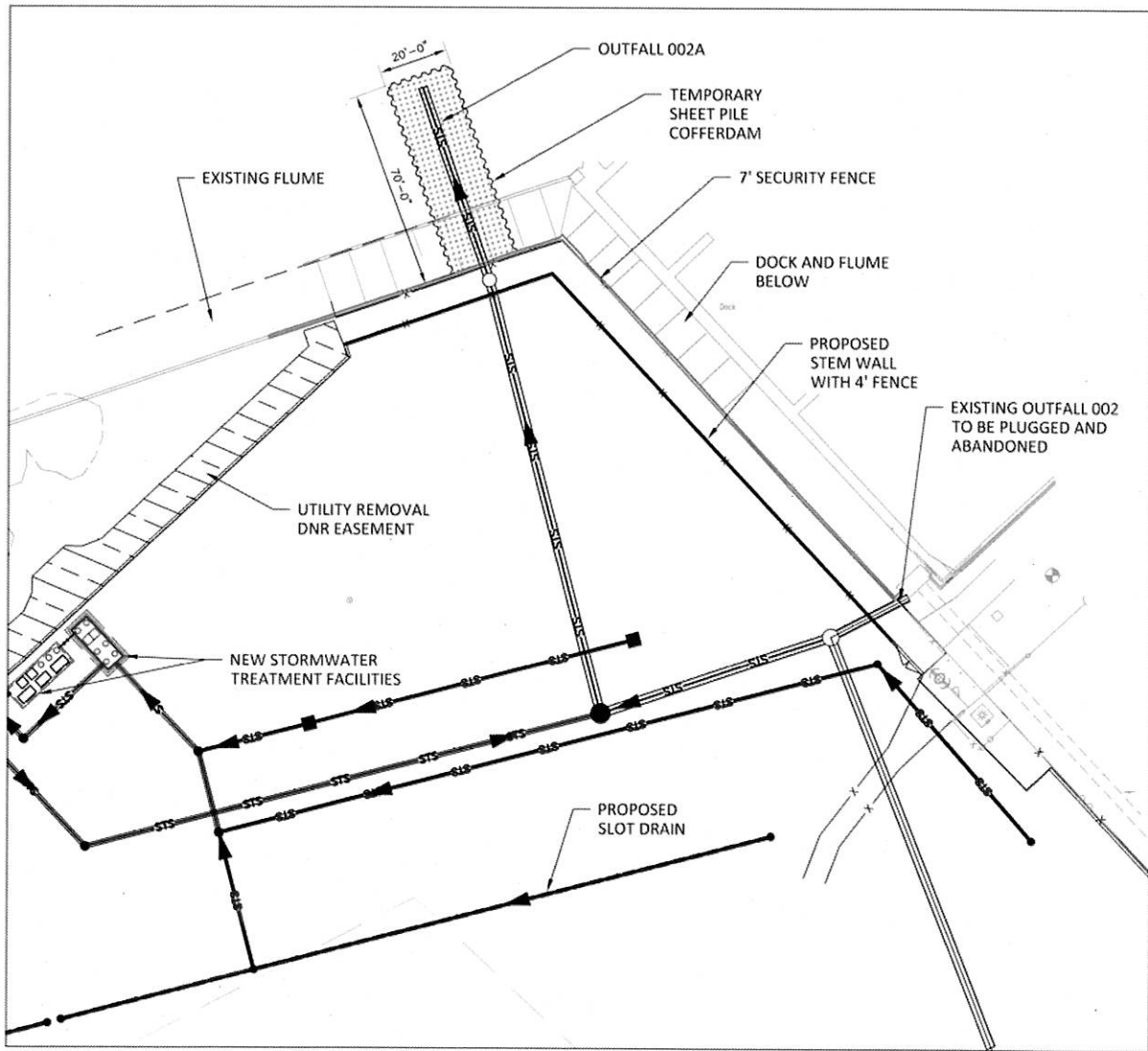

**PLAN OUTFALL 002A**  
 DATUM: NONE

**LEGEND**

 COFFERDAM FOOTPRINT

PURPOSE: APRON R INFRASTRUCTURE IMPROVEMENTS

DATUM: NAVD 88

ADJACENT PROPERTY OWNERS:  
 WDNR, CITY OF RENTON, SOUTHPORT LLC,  
 HOTEL AT SOUTHPORT LLC

NAME: THE BOEING COMPANY

SITE LOCATION ADDRESS:  
 THE BOEING COMPANY  
 737 LOGAN AVE. N.  
 RENTON, WA 98055

REFERENCE NUMBER: NWS-2017-37

IN: LAKE WASHINGTON  
 NEAR/AT: RENTON  
 COUNTY: KING

STATE: WA

SHEET: 14 OF 17

DATE: 10/3/17

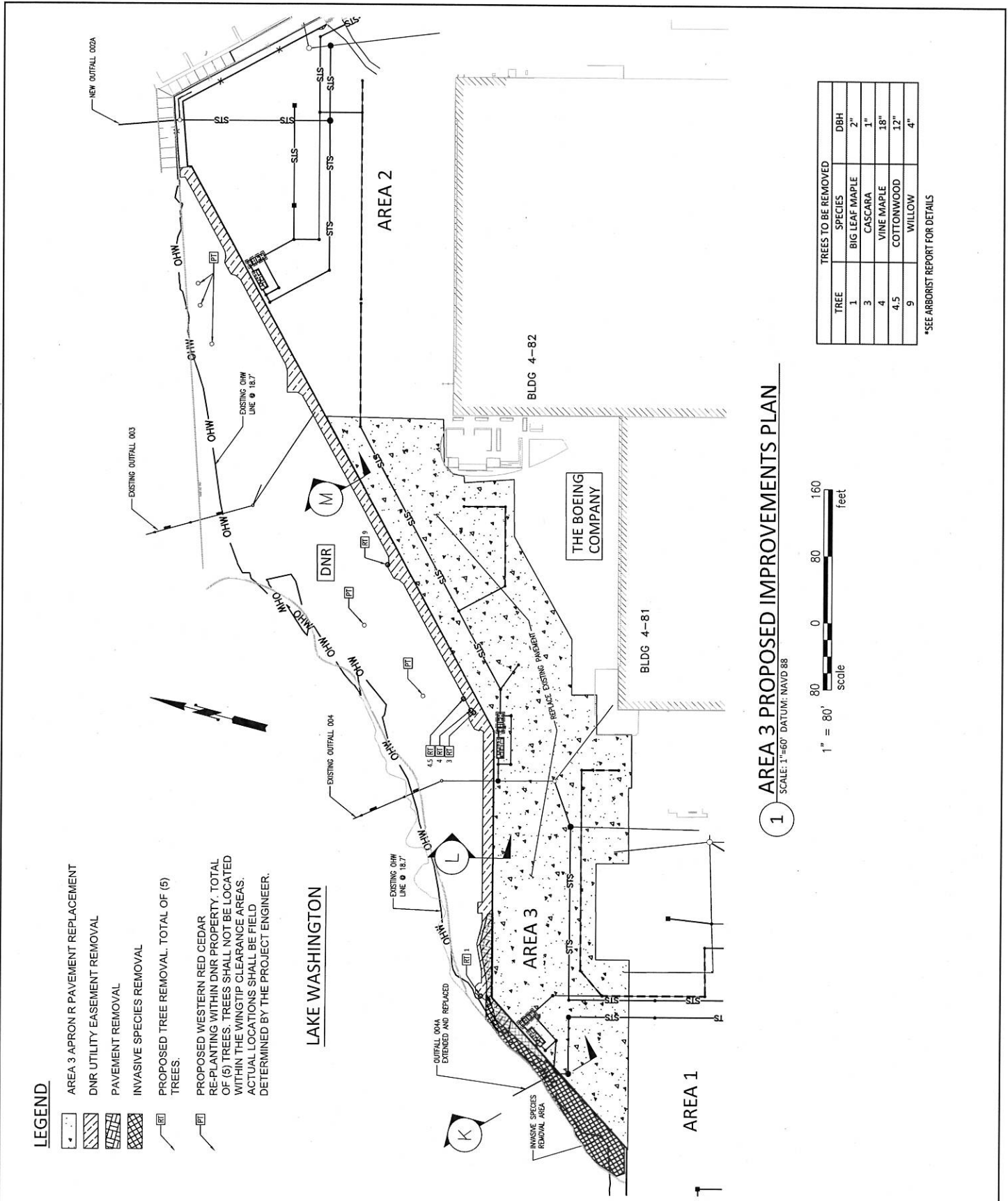

**PURPOSE:** APRON R INFRASTRUCTURE IMPROVEMENTS  
**DATUM:** NAVD 88  
**ADJACENT PROPERTY OWNERS:**  
 WDNR, CITY OF RENTON, SOUTHPORT LLC,  
 HOTEL AT SOUTHPORT LLC

**NAME:** THE BOEING COMPANY  
**SITE LOCATION ADDRESS:**  
 THE BOEING COMPANY  
 737 LOGAN AVE. N.  
 RENTON, WA 98055

**REFERENCE NUMBER:** NWS-2017-37  
**IN:** LAKE WASHINGTON  
**NEAR/AT:** RENTON  
**COUNTY:** KING  
**STATE:** WA  
**SHEET:** 15 OF 17  
**DATE:** 10/3/17

**1 AREA 3 PROPOSED IMPROVEMENTS PLAN**

SCALE: 1"=80' DATUM: NAVD 88



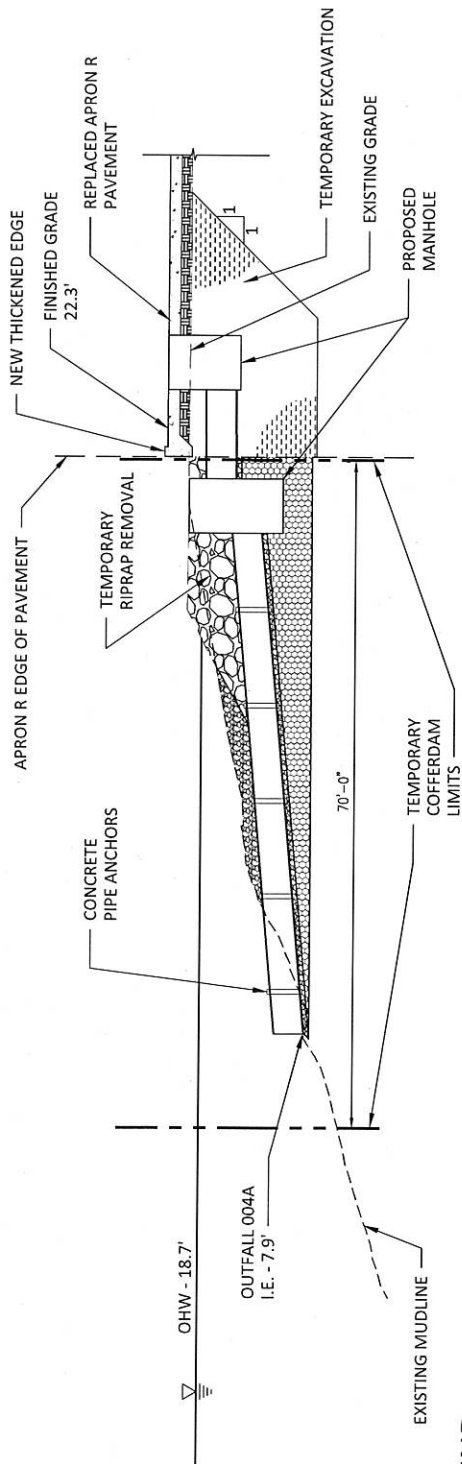

DATUM	NAVD 88	NGVD 29	C.O.E.
OHW	18.7'	15.1'	21.9'

**AREA 3 SECTION K - OUTFALL 004A**  
SCALE: 1"=10' DATUM: NAVD 88

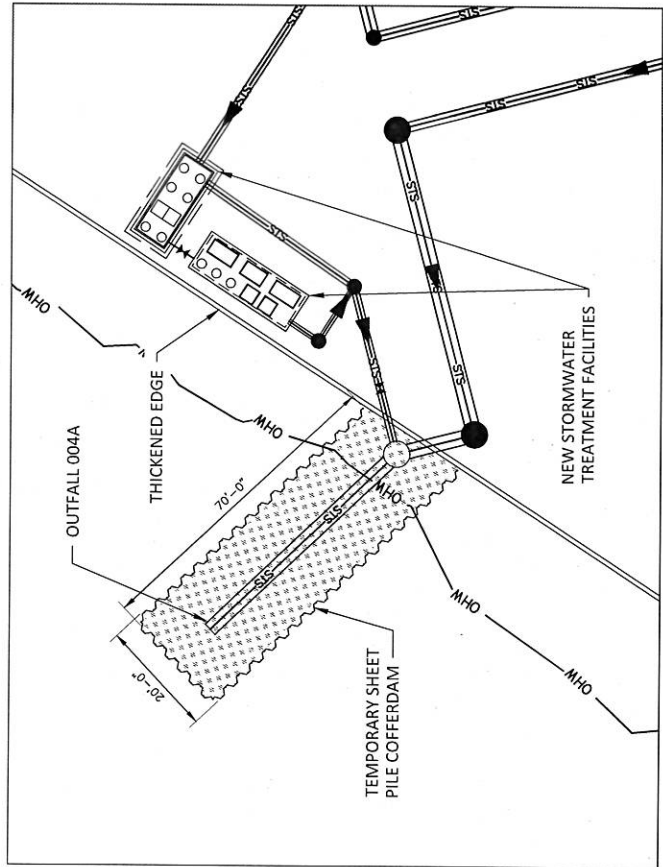

**PLAN OUTFALL 004A**  
DATUM: NONE

**LEGEND**

- STRUCTURAL FILL
- EXCAVATION AND STRUCTURAL FILL
- RIPRAP REMOVAL
- COFFERDAM FOOTPRINT
- 6" STREAMBED COBBLES
- QUARRY SPALLS

PURPOSE: APRON R INFRASTRUCTURE IMPROVEMENTS

DATUM: NAVD 88

ADJACENT PROPERTY OWNERS:  
WDNR, CITY OF RENTON, SOUTHPORT LLC,  
HOTEL AT SOUTHPORT LLC

NAME: THE BOEING COMPANY

SITE LOCATION ADDRESS:  
THE BOEING COMPANY  
737 LOGAN AVE. N.  
RENTON, WA 98055

REFERENCE NUMBER: NWS-2017-37

IN: LAKE WASHINGTON  
NEAR/AT: RENTON  
COUNTY: KING

STATE: WA

SHEET: 16 OF 17

DATE: 10/3/17

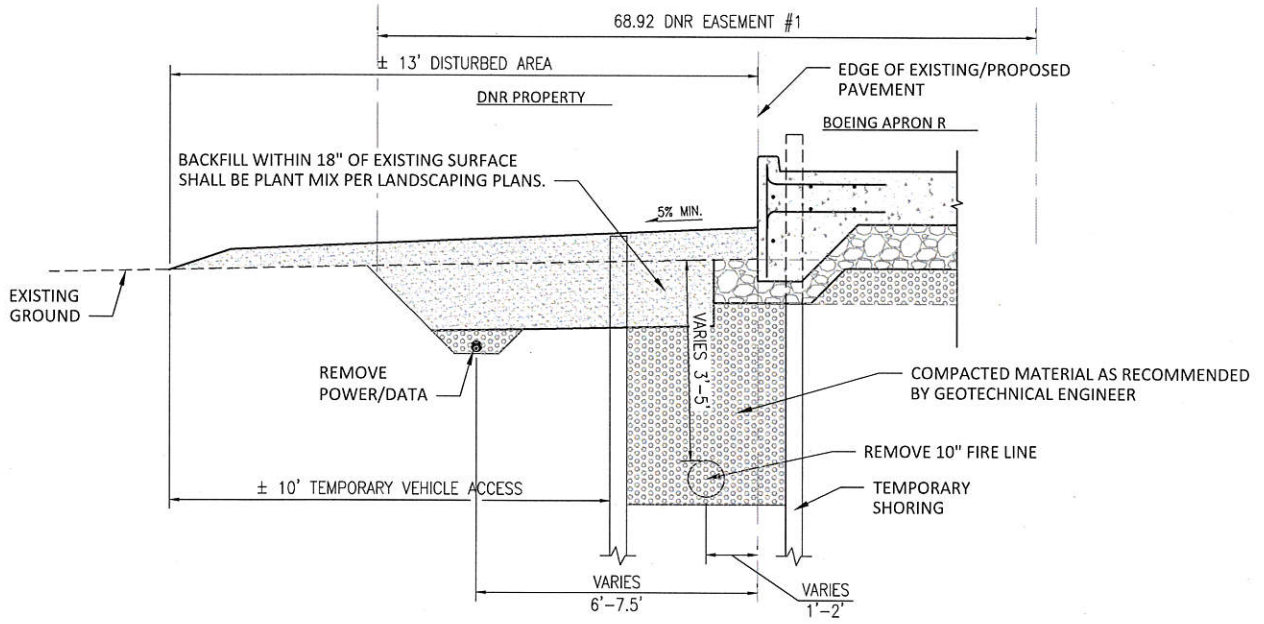

**AREA 3 SECTION L - TYPICAL UTILITY REMOVAL WEST**

SCALE: NTS DATUM: NONE

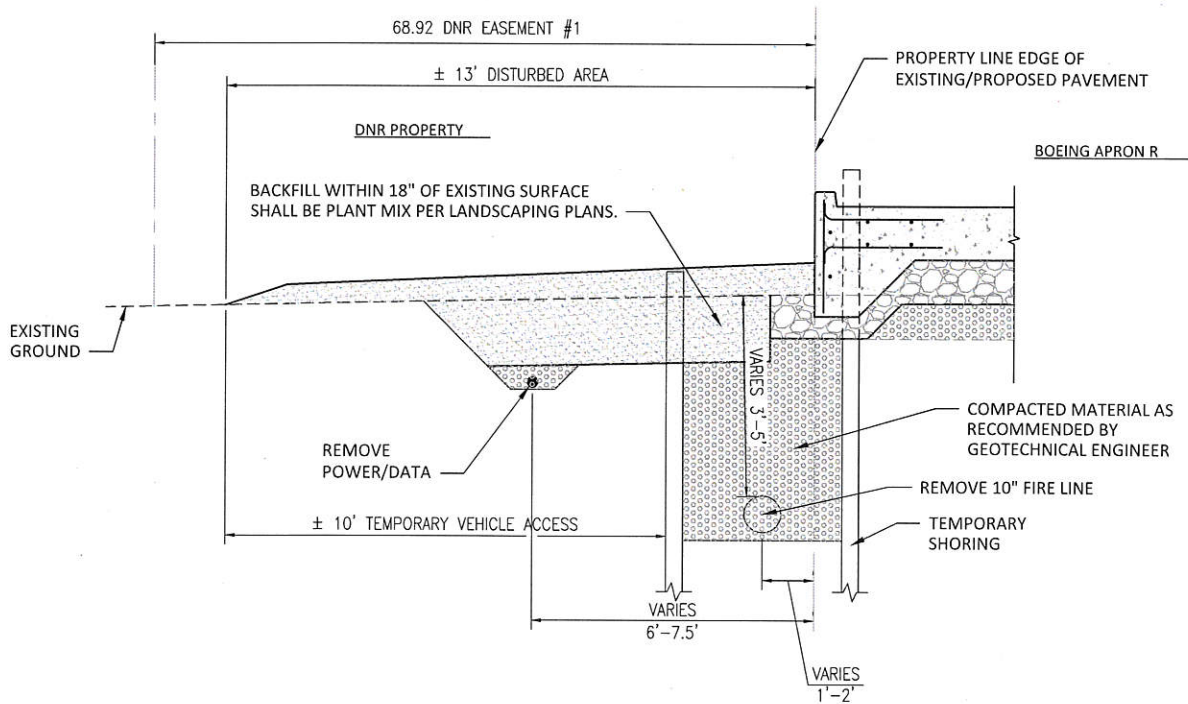

**AREA 2 AND 3 SECTION M - TYPICAL UTILITY REMOVAL EAST**

SCALE: NTS DATUM: NONE

PURPOSE: APRON R INFRASTRUCTURE IMPROVEMENTS

DATUM: NAVD 88

ADJACENT PROPERTY OWNERS:  
WDNR, CITY OF RENTON, SOUTHPORT LLC,  
HOTEL AT SOUTHPORT LLC

NAME: THE BOEING COMPANY

SITE LOCATION ADDRESS:  
THE BOEING COMPANY  
737 LOGAN AVE. N.  
RENTON, WA 98055

REFERENCE NUMBER: NWS-2017-37

IN: LAKE WASHINGTON  
NEAR/AT: RENTON  
COUNTY: KING

STATE: WA

SHEET: 17 OF 17

DATE: 10/3/17