



US Army Corps
of Engineers
Seattle District



WASHINGTON STATE
DEPARTMENT OF
E C O L O G Y

Joint Public Notice

Application for a Department of the Army Permit and a Washington Department of Ecology Water Quality Certification and/or Coastal Zone Management Consistency Concurrence

US Army Corps of Engineers

Regulatory Branch
Post Office Box 3755
Seattle, WA 98124-3755
Telephone: (206) 764-3482
ATTN: Jordan Bunch,
Project Manager

WA Department of Ecology

SEA Program
Post Office Box 47600
Olympia, WA 98504-7600
Telephone: (360) 407-6076
ATTN: SEA Program,
Federal Permit Coordinator

Public Notice Date: August 16, 2018

Expiration Date: September 17, 2018

Reference No.: NWS-2018-722

Name: Spindrift, LLC.

Interested parties are hereby notified that the U.S. Army Corps of Engineers (Corps) and the Washington Department of Ecology (Ecology) have received an application to perform work in waters of the U.S. as described below and shown on the enclosed drawings dated May 17, 2017.

The Corps will review the work in accordance with Section 10 of the Rivers and Harbors Act. Ecology will review the work pursuant to Section 401 of the CWA, with applicable provisions of State water pollution control laws and the Coastal Zone Management Act.

APPLICANT:

Attention: Spindrift, LLC.
P.O. Box 70897
Seattle, WA 98127
Telephone: (360) 319-4932

AGENT:

Attention: Otis, Jeff
393 Bobbyann Road
Eastsound, WA 98245
Telephone: (360) 376-3679

LOCATION: The project is located in Eastsound at 195 Raintree Lane, Eastsound, San Juan County, Washington (48.64417 N, -122.894421 W). A location is shown on Sheet 1 of 11, dated May 17, 2017, prepared by Waterfront Construction, Inc.

WORK: Install a new 4-foot 3-inch wide by 80-foot long fully grated ramp, 8-foot by 8-foot fully grated float, and 8-foot by 40-foot float with 62% functional grating. Total new overwater coverage would be 692 SF and the structure would extend 112.5 feet from the Ordinary High Water Mark. Install two 10-inch diameter steel piling 25 feet waterward of existing vegetation. Install three float anchors.

NWS-2018-722, Spindrift, LLC.

PURPOSE: The purpose of this project is to provide boat moorage and recreational water access.

ENDANGERED SPECIES: The Endangered Species Act (ESA) requires federal agencies to consult with the National Marine Fisheries Service (NMFS) and/or U.S. Fish and Wildlife Service (USFWS) pursuant to Section 7 of the ESA on all actions that may affect a species listed (or proposed for listing) under the ESA as threatened or endangered or any designated critical habitat. After receipt of comments from this public notice, the U.S. Army Corps of Engineers will evaluate the potential impacts to proposed and/or listed species and their designated critical habitat.

ESSENTIAL FISH HABITAT: The Magnuson-Stevens Fishery Conservation and Management Act, as amended by the Sustainable Fisheries Act of 1996, requires all Federal agencies to consult with the NMFS on all actions, or proposed actions, permitted, funded, or undertaken by the agency, that may adversely affect Essential Fish Habitat (EFH). The proposed action would impact EFH in the project area.

If the U.S. Army Corps of Engineers (Corps) determines that the proposed action may adversely affect EFH for federally managed fisheries in Washington waters, the Corps will initiate EFH consultation with the NMFS. The Corps' final determination relative to project impacts and the need for mitigation measures is subject to review by and coordination with the NMFS.

CULTURAL RESOURCES: The Corps has reviewed the latest published version of the National Register of Historic Places, Washington Information System for Architectural and Archaeological Records Data and other sources of information. Historic properties are recorded near the proposed project. However, they do not occur in the permit area. The permit area was created in modern times and there is little likelihood that the proposed project will impinge on any historic property. The Corps invites responses to this public notice from Native American Tribes or Tribal governments; Federal, State, and local agencies; historical and archeological societies; and other parties likely to have knowledge of or concerns regarding historic properties and sites of religious and cultural significance at or near the project area. After receipt of comments from this public notice, the Corps will evaluate potential impacts and consult with the State Historic Preservation Officer and Native American Tribes in accordance with Section 106 of the National Historic Preservation Act, as appropriate.

EVALUATION – CORPS: The decision whether to issue a permit will be based on an evaluation of the probable impacts, including cumulative impacts, of the proposed activity on the public interest. That decision will reflect the national concern for both protection and utilization of important resources. The benefits, which reasonably may be expected to accrue from the proposal, must be balanced against its reasonably foreseeable detriments. All factors which may be relevant to the proposal will be considered, including the cumulative effects thereof; among those are conservation, economics, aesthetics, general environmental concerns, wetlands, historic properties, fish and wildlife values, flood hazards, floodplain values, land use, navigation, shoreline erosion and accretion, recreation, water supply and conservation, water quality, energy needs, safety, food and fiber production, mineral needs, considerations of property ownership, and, in general, the needs and welfare of the people.

The Corps is soliciting comments from the public; Native American Nations or Tribal governments; Federal, State, and local agencies and officials; and other interested parties in order to consider and evaluate the impacts of this activity. Any comments received will be considered by the Corps to determine whether to issue, modify, condition or deny a permit for the work. To make this decision, comments are used to assess impacts on endangered species, historic properties, water quality, general environmental effects, and the other public interest factors listed above. Comments are used in the preparation of an Environmental Assessment and/or an Environmental Impact Statement pursuant to the National Environmental Policy Act. Comments are also used to determine the need for a public hearing and to determine the overall public interest of the activity.

NWS-2018-722, Spindrift, LLC.

EVALUATION – ECOLOGY: Ecology is soliciting comments from the public; Federal, Native American Nations or Tribal governments, State, and local agencies and officials; and other interested parties in order to consider and evaluate the impacts of this activity. Ecology will be considering all comments to determine whether to certify or deny certification for the proposed project.

ADDITIONAL EVALUATION: This proposal is the subject of Shorelines Substantial Development Permit No. ***, being processed by ***.

COMMENT AND REVIEW PERIOD: Conventional mail or e-mail comments on this public notice will be accepted and made part of the record and will be considered in determining whether authorizing the work would not be contrary to the public interest. In order to be accepted, e-mail comments must originate from the author's e-mail account and must include on the subject line of the e-mail message the permit applicant's name and reference number as shown below. Either conventional mail or e-mail comments must include the permit applicant's name and reference number, as shown below, and the commenter's name, address, and phone number. All comments whether conventional mail or e-mail must reach this office, no later than the expiration date of this public notice to ensure consideration.

CORPS COMMENTS: All e-mail comments should be sent to jordan.a.bunch@usace.army.mil. Conventional mail comments should be sent to: U.S. Army Corps of Engineers, Regulatory Branch, Attention: Jordan Bunch, P.O. Box 3755, Seattle, Washington 98124-3755. All comments received will become part of the administrative record and are subject to public release under the Freedom of Information Act including any personally identifiable information such as names, phone numbers, and addresses.

ECOLOGY COMMENTS: Any person desiring to present views on the project pertaining to a request for water quality certification under Section 401 of the CWA and/or Coastal Zone Management consistency concurrence, may do so by submitting written comments to the following address: Washington State Department of Ecology, Attention: Federal Permit Coordinator, Post Office Box 47600, Olympia, Washington 98504-7600, or e-mail to ecyrefedpermits@ecy.wa.gov.

To ensure proper consideration of all comments, responders must include the following name and reference number in the text of their comments: Spindrift, LLC; NWS-2018-722

Encl: Figures (11)

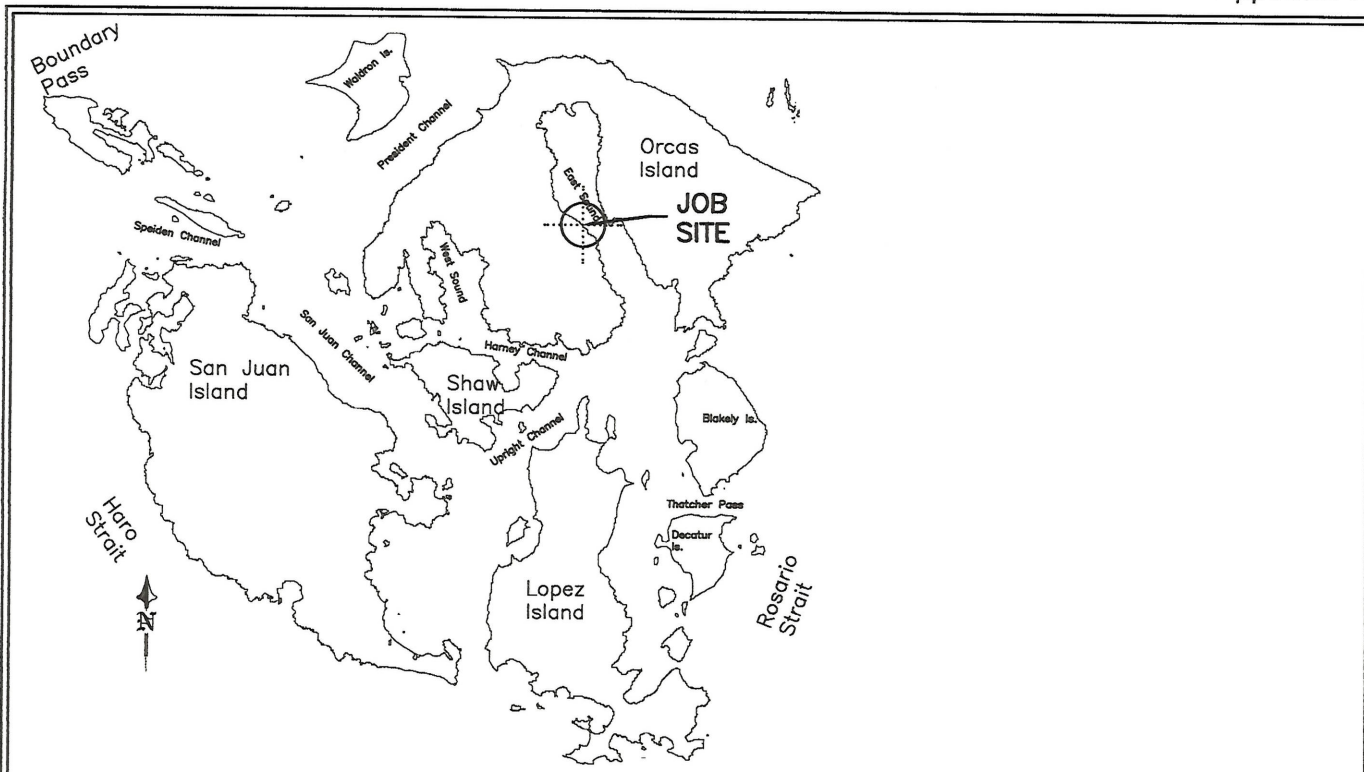

AREA MAP/NO SCALE

LEGAL DESCRIPTIONS

SPINDRIFT LLC

1/4 SEC: SEC1-T36N R2W LAT: 48.6441700 (48° 38' 39.01" N)
 TAXLOT #: 260121007000 LONG: -122.8944210 (122° 53' 39.92" W)
 PRS GLS 1 & 2 Sec 01, T 36N, R 2W

LANGSTRAAT

1/4 SEC: SEC1-T36N R2W LAT: 48.6434611 (48° 38' 36.46" N)
 TAXLOT #: 260121005000 LONG: -122.8939382 (122° 53' 38.18" W)
 THE UPLANDS DIV 2 SHORT PLAT - LOT 3 Sec 01, T 36N, R 2W

NWS-2018 - 722

PROJECT DESIGNED BY:
Waterfront Construction Inc.

THIS DOCUMENT IS PROPRIETARY PROPERTY OF WATERFRONT CONSTRUCTION INC., AND IS NOT TO BE USED, IN WHOLE OR IN PART, FOR ANY OTHER PROJECT WITHOUT THE WRITTEN AUTHORIZATION OF WATERFRONT CONSTRUCTION INC.

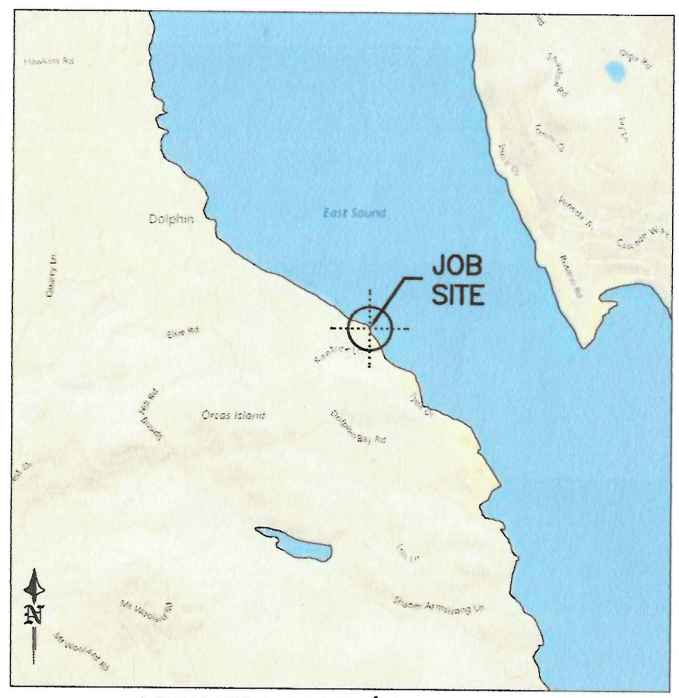

VICINITY MAP/NO SCALE

ADJACENT OWNERS: ① JOHN M CHERRY TTEE 5003 102ND NE KIRKLAND, WA. 98033 ② JOHN M CHERRY TTEE 5003 102ND NE KIRKLAND, WA. 98033 ③ EDGAR & JUDITH ZIMMERMAN TTEES 340 RAINTREE LANE EASTSOUND, WA. 98245	PROJECT NAME: SPINDRIFT LLC (PHASE 2) PURPOSE: PROVIDE PRIVATE MOORAGE.	REFERENCE #: PROPOSED: INSTALL A NEW FULLY GRATED JU RAMP & FLOAT. REMOVE EXISTING CONCRETE FOOTINGS, ROCK RUBBLE AND CONCRETE STAIRS	DATUM: MLLW = 0.00'	
	SITE ADDRESS: 195 RAINTREE LANE EASTSOUND, WA. 98245	NEAR/AT: ORCAS ISLAND COUNTY: SAN JUAN APPL BY: SPINDRIFT LLC	IN: EAST SOUND STATE: WASHINGTON	
	MAILING ADDRESS: PO BOX 70897 SEATTLE WA 98127-0135	SHEET: 1 OF: 11	DATE: 5-17-17	
	DWG#: 16-37076-A1-1			

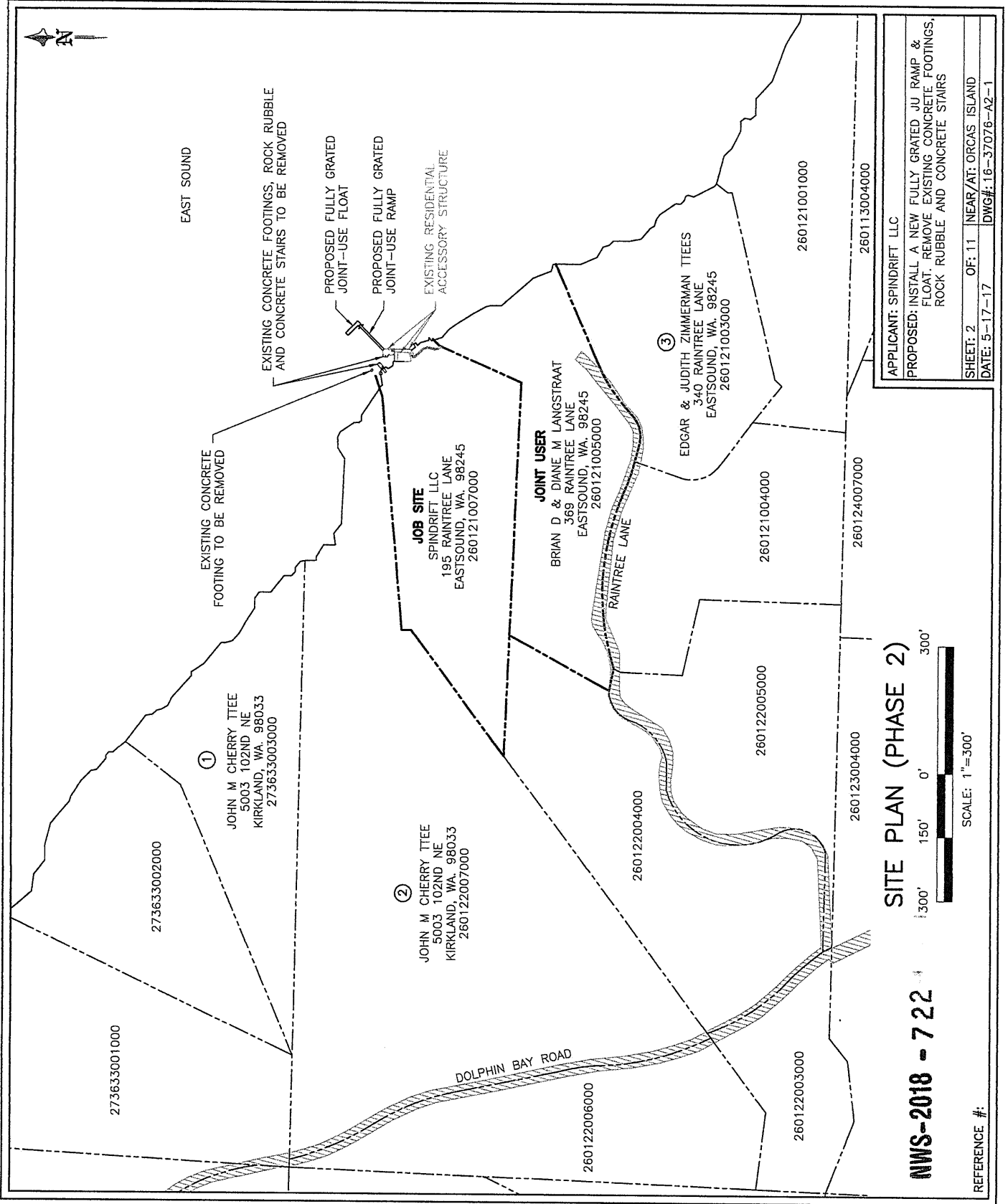

PROJECT DESIGNED BY:
Waterfront Construction Inc.
 THIS DOCUMENT IS **PROPRIETARY** PROPERTY OF WATERFRONT CONSTRUCTION INC., AND IS NOT TO BE USED, IN WHOLE OR IN PART, FOR ANY OTHER PROJECT WITHOUT THE WRITTEN AUTHORIZATION OF WATERFRONT CONSTRUCTION INC.

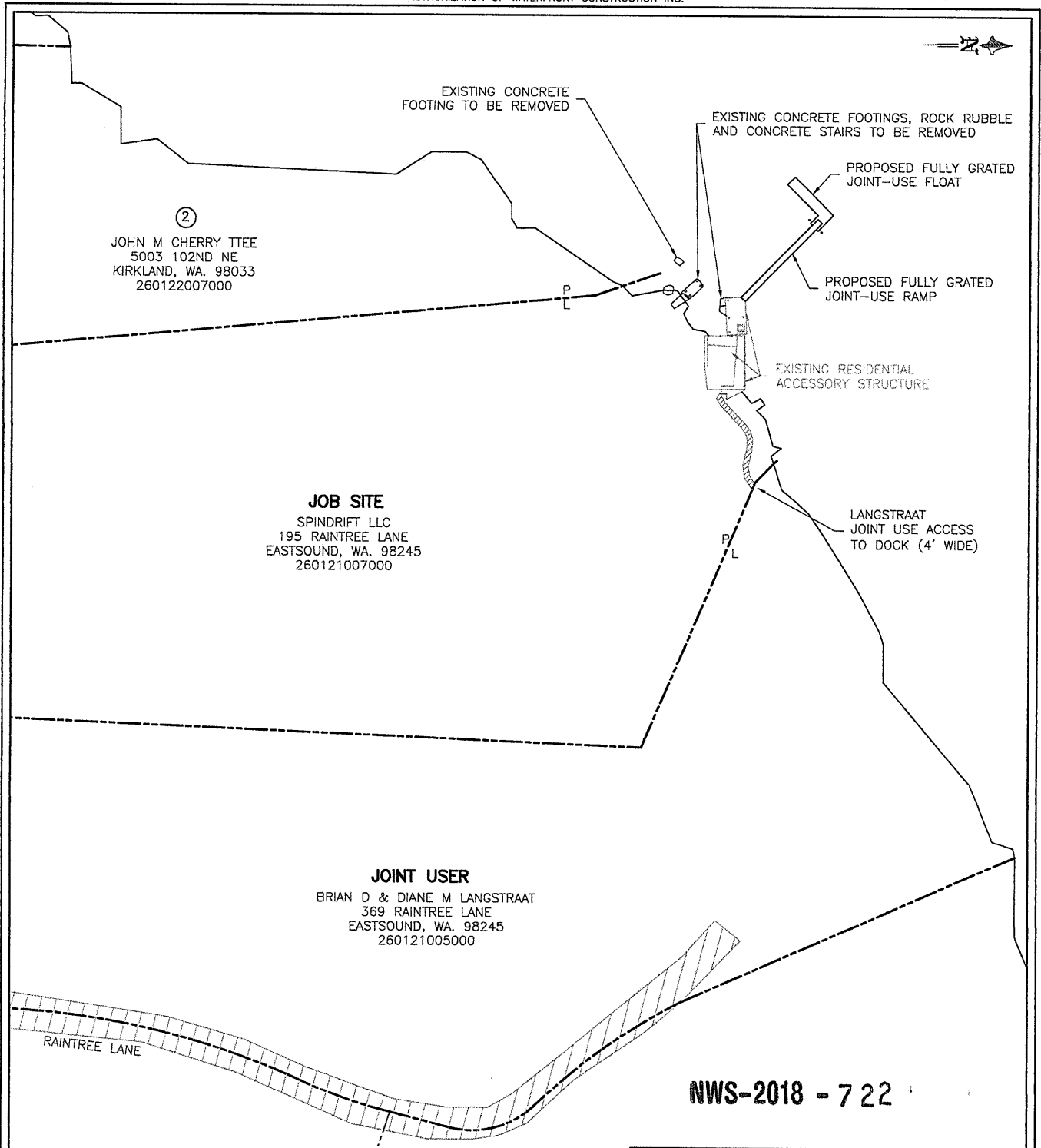
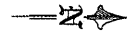

PLAN VIEW (PHASE 2)

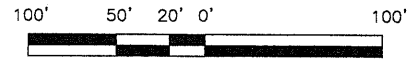

SCALE: 1"=100'

REFERENCE #:

NWS-2018 - 7 22

APPLICANT: SPINDRIFT LLC		
PROPOSED: INSTALL A NEW FULLY GRATED JU RAMP & FLOAT. REMOVE EXISTING CONCRETE FOOTINGS, ROCK RUBBLE AND CONCRETE STAIRS		
SHEET: 3	OF: 11	NEAR/AT: ORCAS ISLAND
DATE: 5-17-17	DWG#: 16-37076-A3-1	

NWS-2018 - 722

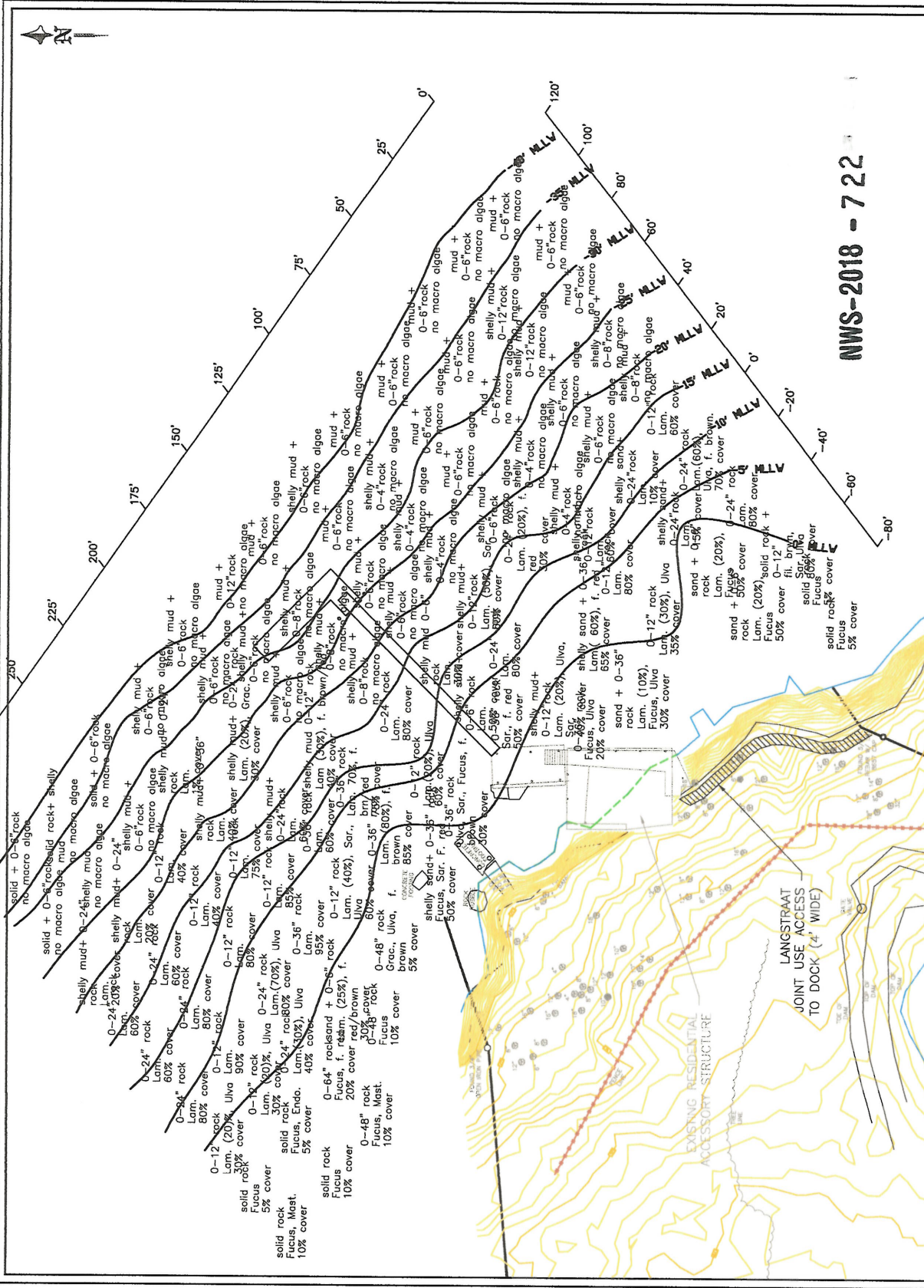

REFERENCE #:

PROJECT DESIGNED BY:
Waterfront Construction Inc.
 THIS DOCUMENT IS PROPRIETARY PROPERTY OF WATERFRONT CONSTRUCTION INC., AND IS NOT TO BE USED, IN WHOLE OR IN PART, FOR ANY OTHER PROJECT WITHOUT THE WRITTEN AUTHORIZATION OF WATERFRONT CONSTRUCTION INC.

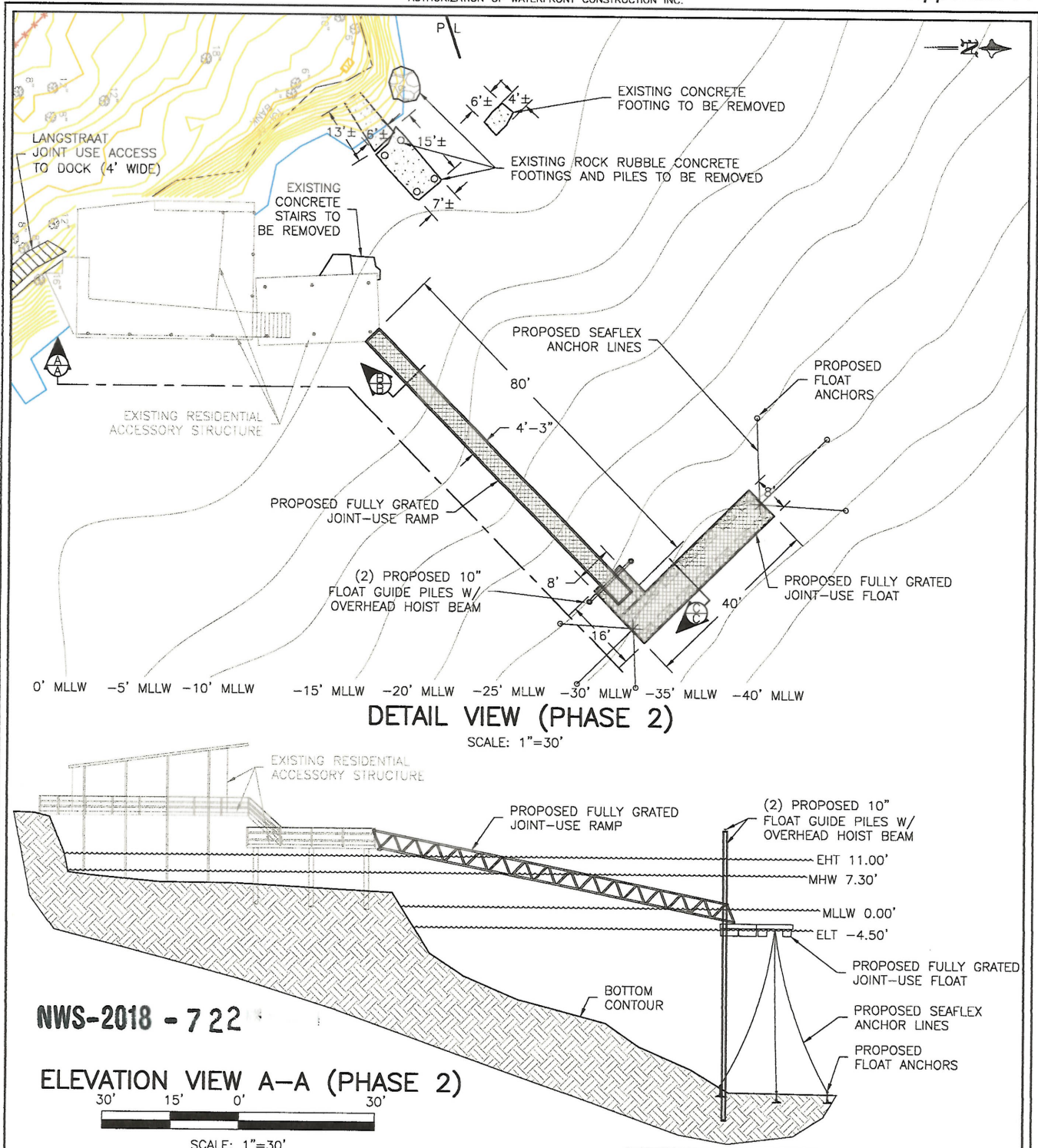

NWS-2018 - 722

ELEVATION VIEW A-A (PHASE 2)

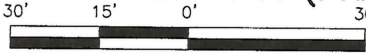

SCALE: 1"=30'

PROPOSED RAMP	320.5 S/F
PROPOSED RAMP FLOAT	64 S/F
PROPOSED FLOAT	320 S/F
LESS RAMP OVERLAP	-14.5 S/F
TOTAL:	692 S/F

REFERENCE #:

APPLICANT: SPINDRIFT LLC

PROPOSED: INSTALL A NEW FULLY GRATED JU RAMP & FLOAT. REMOVE EXISTING CONCRETE FOOTINGS, ROCK RUBBLE AND CONCRETE STAIRS

SHEET: 5 OF: 11 NEAR/AT: ORCAS ISLAND

DATE: 5-17-17 DWG#: 16-37076-A5-1

PROJECT DESIGNED BY:
Waterfront Construction Inc.
 THIS DOCUMENT IS **PROPRIETARY** PROPERTY OF WATERFRONT
 CONSTRUCTION INC., AND IS NOT TO BE USED, IN WHOLE OR IN
 PART, FOR ANY OTHER PROJECT WITHOUT THE WRITTEN
 AUTHORIZATION OF WATERFRONT CONSTRUCTION INC.

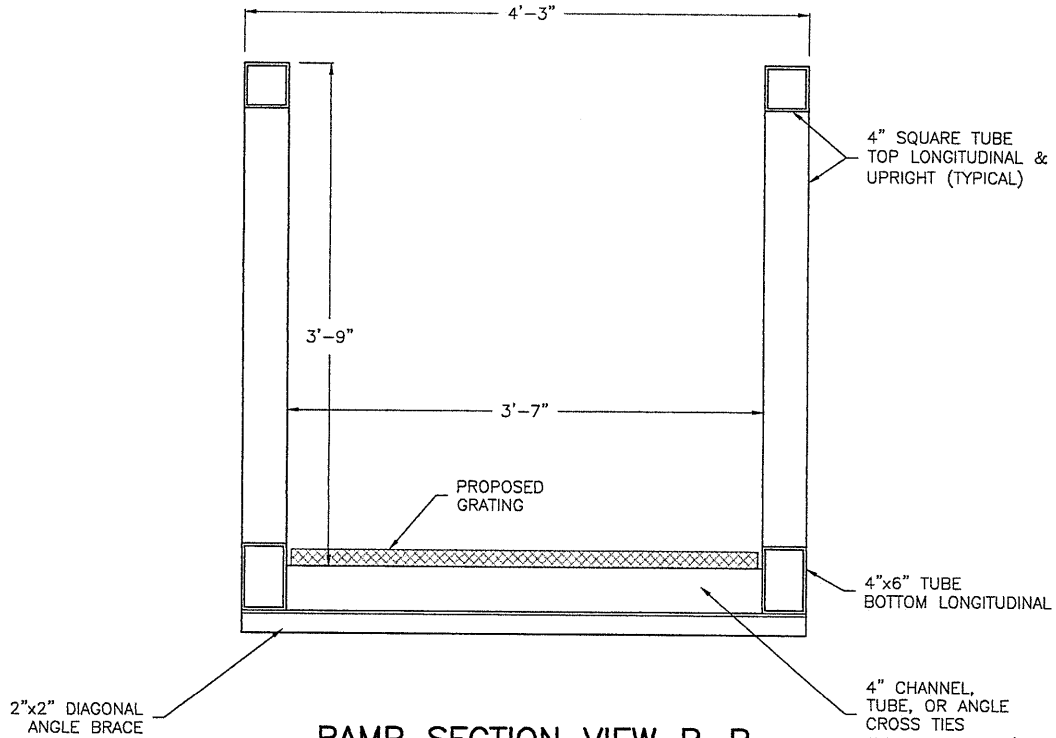

RAMP SECTION VIEW B-B

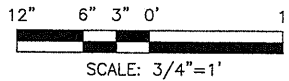

NWS-2018 - 7 22

APPLICANT: SPINDRIFT LLC		
PROPOSED: INSTALL A NEW FULLY GRATED JU RAMP & FLOAT. REMOVE EXISTING CONCRETE FOOTINGS, ROCK RUBBLE AND CONCRETE STAIRS		
SHEET: 6	OF: 11	NEAR/AT: ORCAS ISLAND
DATE: 5-17-17	DWG#: 16-37076-A6-1	

REFERENCE #:

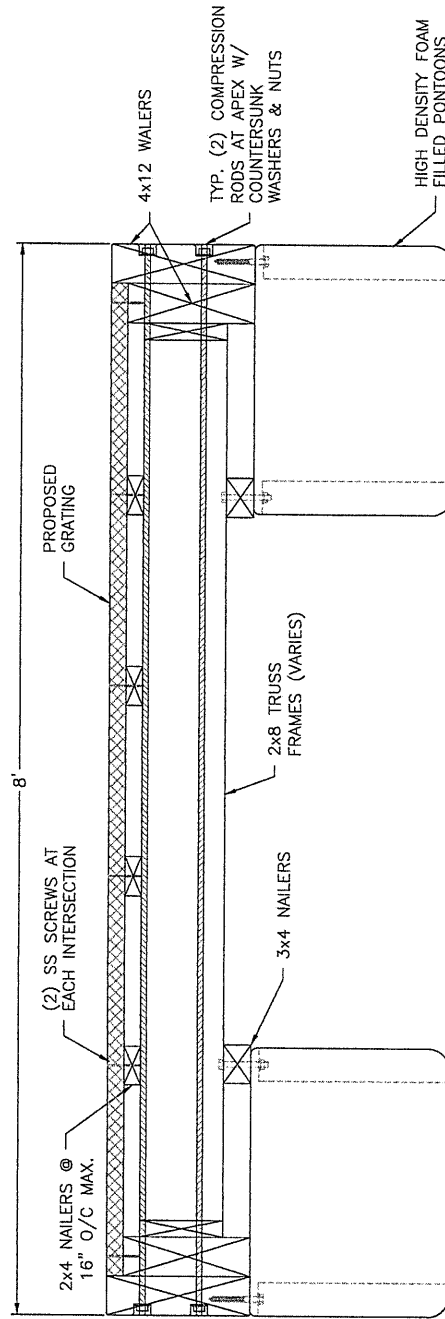

FLOAT SECTION VIEW C-C

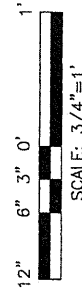

NWS-2018 - 722

FLOAT MATERIAL LIST

PART	SPECS	TREATMENT
PILING	10" STD WALL	EPOXY COATED
WALERS	4"x12" DF #2 OR BTR	ACZA
JOIST	2"x8" DF #2 OR BTR	ACZA
RIM JOIST	2"x8" DF #2 OR BTR	ACZA
DIAGONALS	2"x8" DF #2 OR BTR	ACZA
NAILERS	2"x4" & 3"x4" DF #2 OR BTR	ACZA
GRATING	MOLDED PLASTIC	NONE
HARDWARE	STEEL	STAINLESS OR HDG.

REFERENCE #:

APPLICANT: SPINDRIFT LLC
 PROPOSED: INSTALL A NEW FULLY GRATED JU RAMP & FLOAT. REMOVE EXISTING CONCRETE FOOTINGS, ROCK RUBBLE AND CONCRETE STAIRS
 SHEET: 7 OF: 11 NEAR/AT: ORCAS ISLAND
 DATE: 5-17-17 DWG#: 16-37076-A7-1

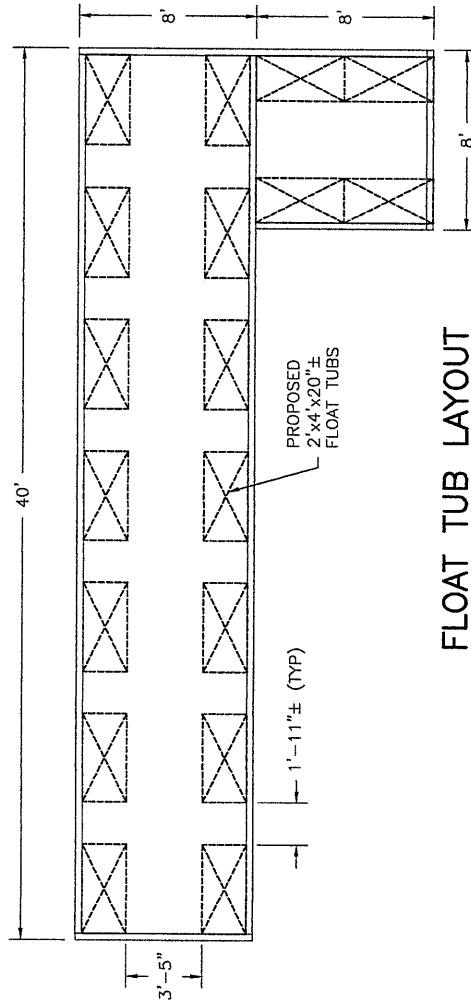

NWS-2018 - 722

FLOAT TUB LAYOUT

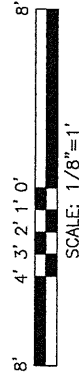

APPLICANT: SPINDRIFT LLC	
PROPOSED: INSTALL A NEW FULLY GRATED JU RAMP & FLOAT. REMOVE EXISTING CONCRETE FOOTINGS, ROCK RUBBLE AND CONCRETE STAIRS	
SHEET: 8	OF: 11
DATE: 5-17-17	NEAR/AT: ORCAS ISLAND
	DWG#: 16-37076-AB-1

OVERALL FLOAT GRATING = 349 S/F
 GRATING FUNCTIONAL OPEN AREA = 206± S/F

REFERENCE #:

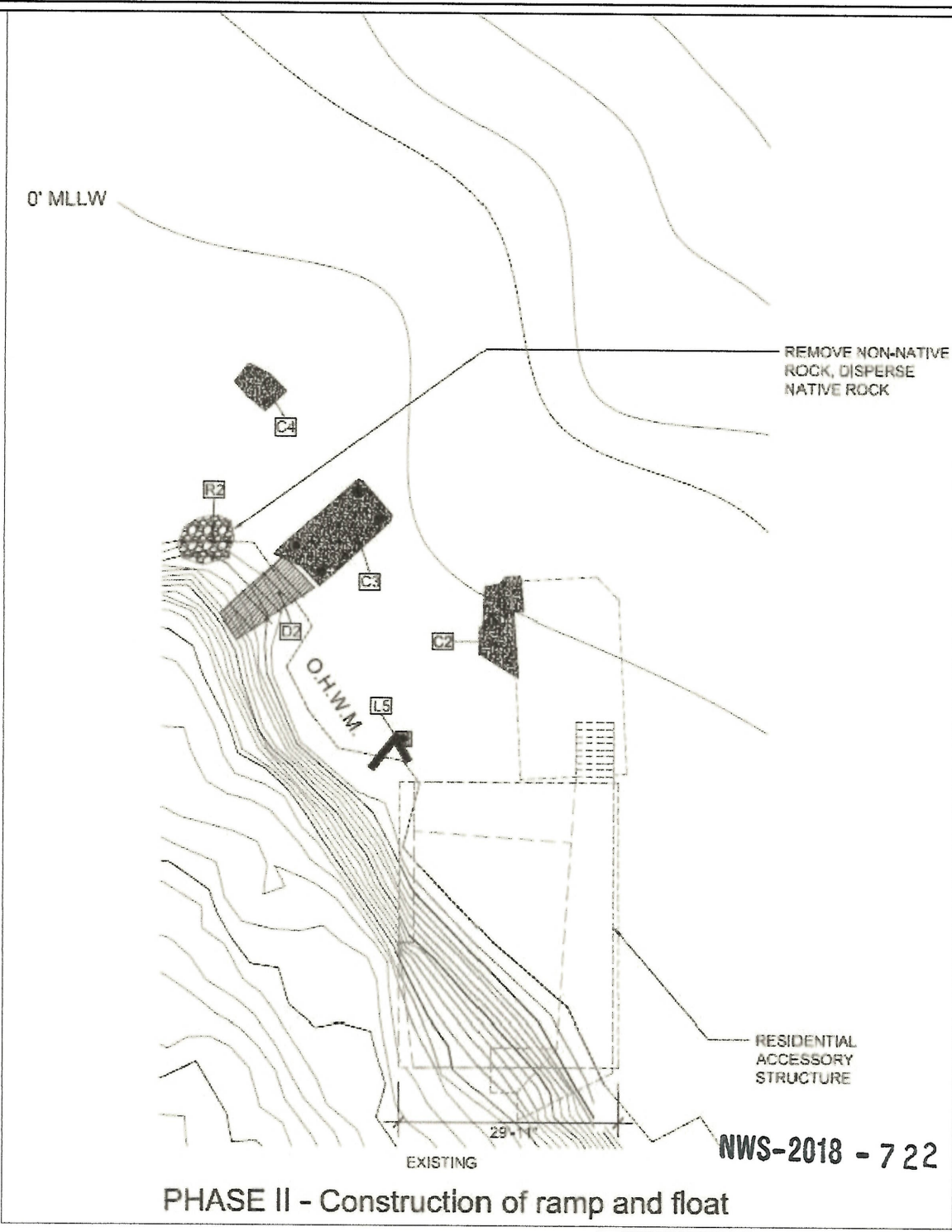

PHASE II - Construction of ramp and float

NWS-2018 - 722

prentiss + balance + wickline
ARCHITECTS

REFERENCE #:

APPLICANT: SPINDRIFT LLC		
PROPOSED: INSTALL A NEW FULLY GRATED JU RAMP & FLOAT. REMOVE EXISTING CONCRETE FOOTINGS, ROCK RUBBLE AND CONCRETE STAIRS		
SHEET: 9	OF: 11	NEAR/AT: ORCAS ISLAND
DATE: 5-17-17	DWG#: 16-37076-A9-1	

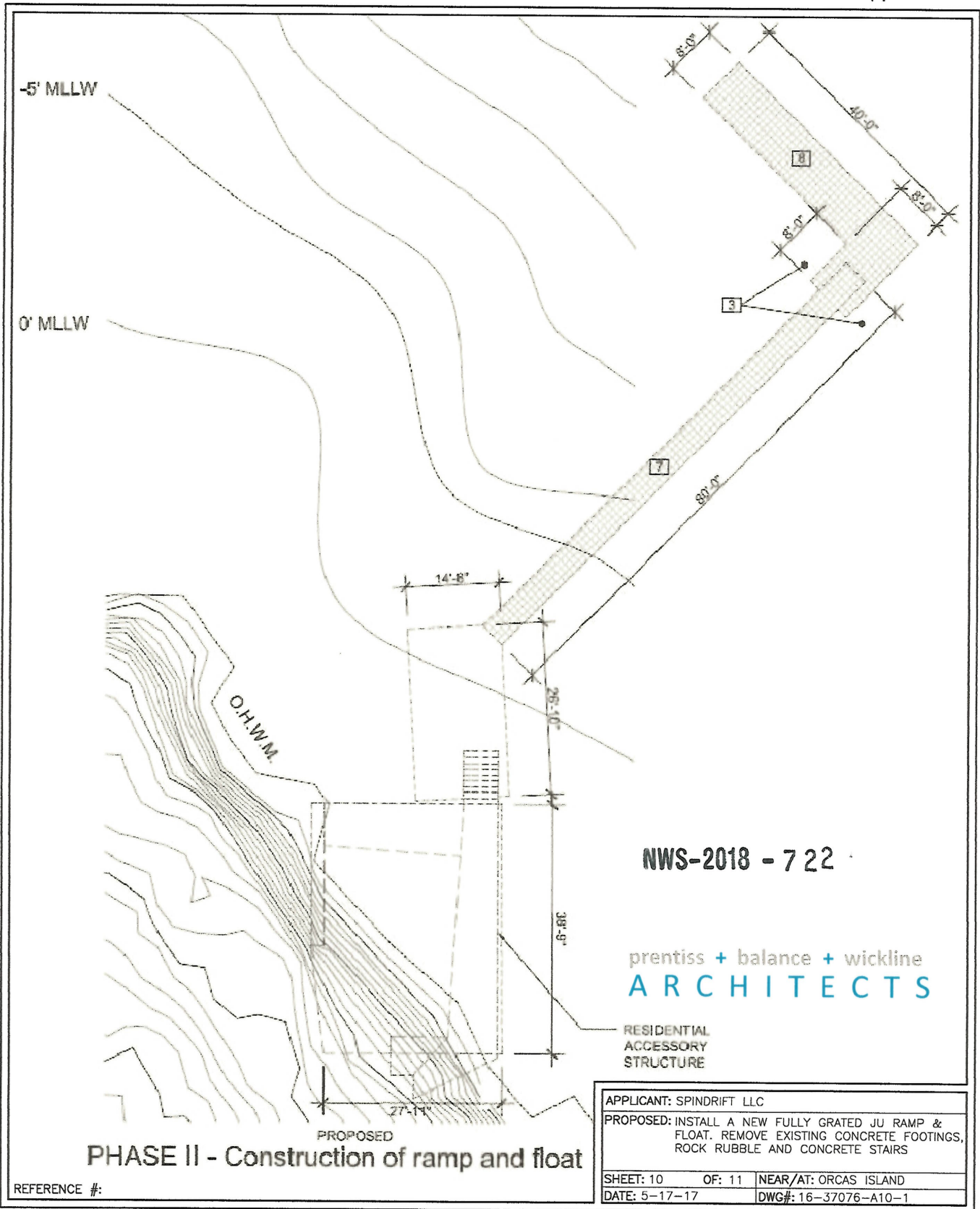

Existing Structure Bearing Directly on Bottom		ID #
Concrete Structures	217 ft ²	C2-C4
Logs, Piers and Footings	9 ft ²	L5
Rubble	40 ft ²	R2
Total	266 ft²	
Phase 1 & 2 Structure Bearing Directly on Bottom		ID #
Dock Piles	1.1 ft ²	3
Total	1 ft²	
Change	-265 ft²	
Percent Reduction	99.6%	

Existing Coverage and Remnants		ID #
Repaired Residential Accessory	1526 ft ²	
Concrete Dock Remnant	217 ft ²	C2-C5
Wood Dock Remnant	61 ft ²	D2
Rubble Pile	40 ft ²	R2
Logs and Footing	9 ft ²	L5
Total	1853 ft²	
Phase 1 & 2 Proposed Coverage		ID #
Repaired Residential Accessory	1526 ft ²	
Ramp and Float	692 ft ²	7, 8
Total	2218 ft²	
Change	365 ft²	
Total Dock Area*	1390 ft²	

*Includes accessory structure dock access



60% OPEN GRATE DECKING ABOVE

NWS-2018 - 7 22

prentiss + balance + wickline
ARCHITECTS

REFERENCE #:

APPLICANT: SPINDRIFT LLC		
PROPOSED: INSTALL A NEW FULLY GRATED JU RAMP & FLOAT. REMOVE EXISTING CONCRETE FOOTINGS, ROCK RUBBLE AND CONCRETE STAIRS		
SHEET: 11	OF: 11	NEAR/AT: ORCAS ISLAND
DATE: 5-17-17	DWG#: 16-37076-A11-1	